

FLAT COPING

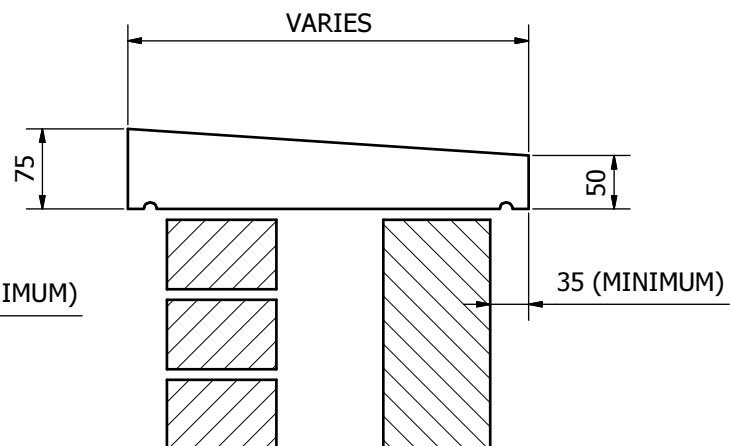

ONCE WEATHERED COPING

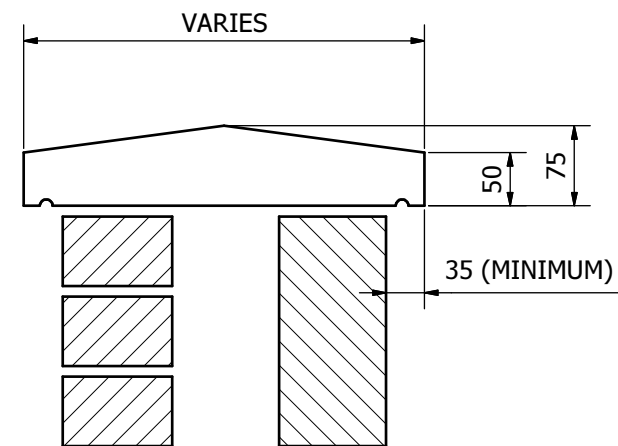

TWICE WEATHERED COPING

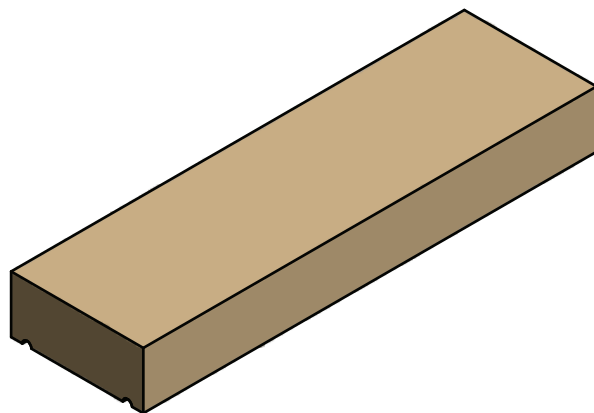

C175-F COPING

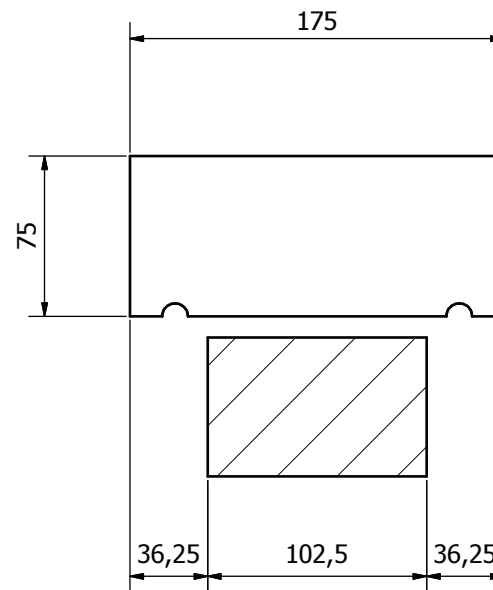

TYPICAL SECTION

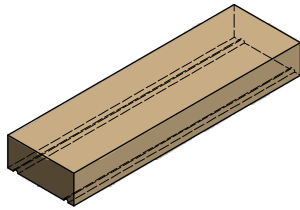

C175-F - STRAIGHT
APPROX. 18 kg

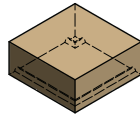

C175-FX90 - INT/EXT 90°
APPROX. 5 kg

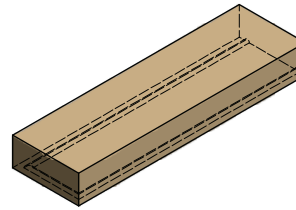

C175-FL - STOP END
APPROX. 18 kg

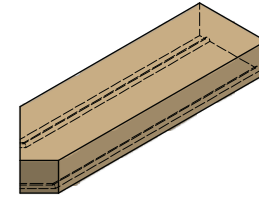

C175-FX45L - INT/EXT 45° L/H (AS DRAWN)
C175-FX45R - INT/EXT 45° R/H (HANDED)
APPROX. 16 kg

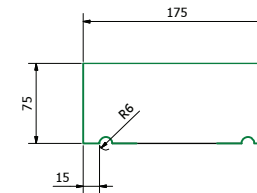
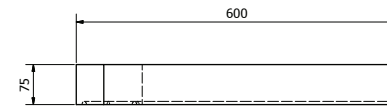
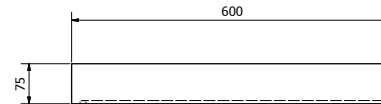
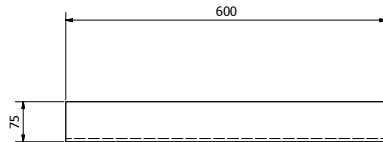
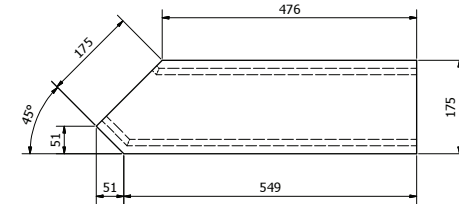
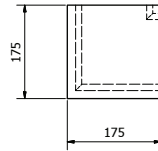
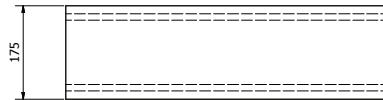

TYPICAL SECTION (1 : 2.5)

VOBSTER
ARCHITECTURAL

Vobster Architectural
Newbury Works
Coleford, Radstock
Somerset, BA3 9RX
Tel: +44 (0)203 968 7058
Email: enquiries@vobsterarchitectural.co.uk
Web: www.vobsterarchitectural.co.uk

It is the responsibility of the customer to ensure the suitability of any of these products within their project. Vobster Architectural Ltd. can accept no responsibility for the accuracy or suitability of any information produced and offer no warranty whatsoever in this respect. All units weigh approx. 2.4 tonnes/m² although this will depend on the chosen rim design - please therefore contact us for confirmation of weights. To comply with CEN regulations please notify us if you require lifting sockets to be incorporated into units at time of order.

KEY
— DENOTES FINISHED FACES
→ DENOTES DIRECTION OF WEATHERING

SCALE 1:5 U.S.O.

TITLE
FLAT COPING (C175-F)

Drawing No. VC-CPF-05 **Rev** 1

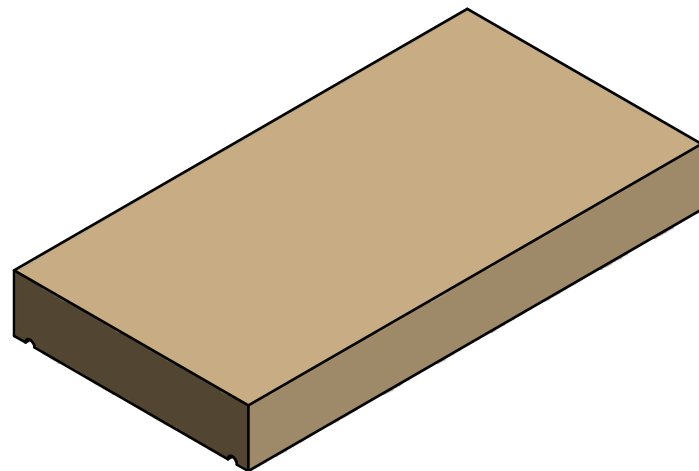

C310-F COPING

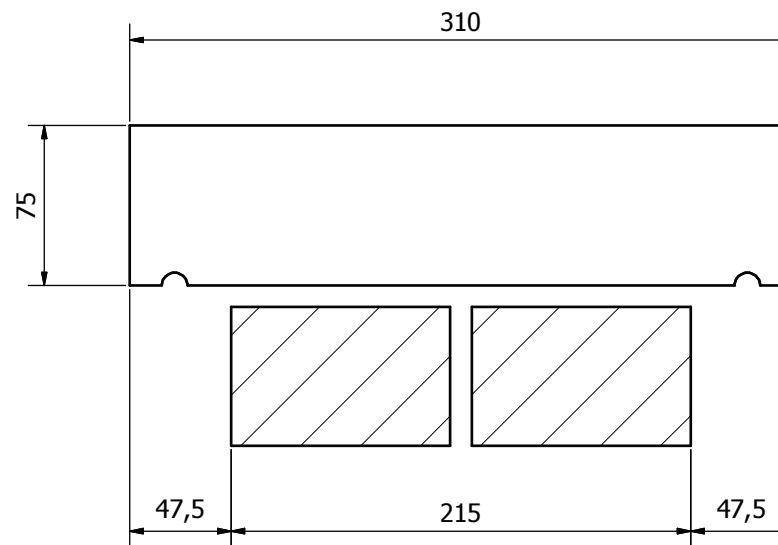

TYPICAL SECTION (215mm WALL)

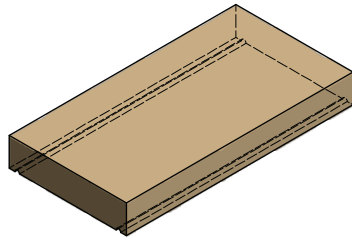

C310-F - STRAIGHT
APPROX. 32 kg

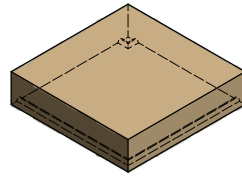

C310-FX90 - INT/EXT 90°
APPROX. 16 kg

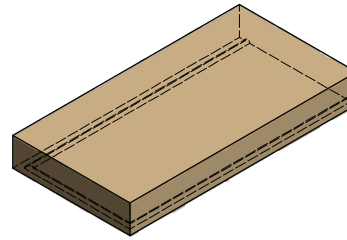

C310-FL - STOP END
APPROX. 32 kg

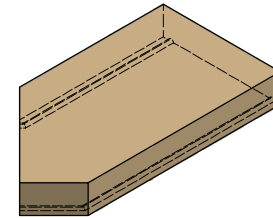

C310-FX45L - INT/EXT 45° L/H (AS DRAWN)
C310-FX45R - INT/EXT 45° R/H (HANDED)
APPROX. 27 kg

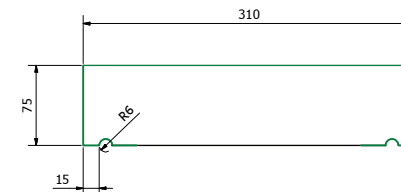
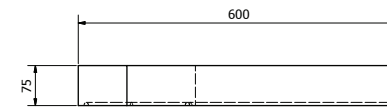
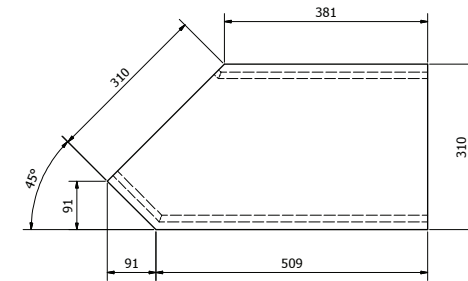
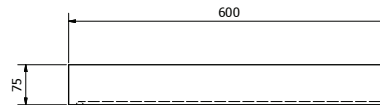
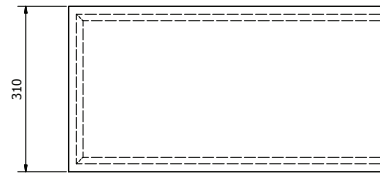
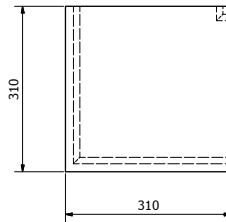
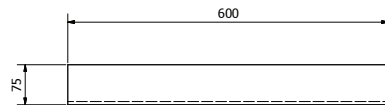

TYPICAL SECTION (1 : 2.5)

VOBSTER

ARCHITECTURAL

Vobster Architectural
Newbury Works
Coleford, Radstock
Somerset, BA3 9RX
T: +44 (0)1203 958 7058
E: enquiries@vobsterarchitectural.co.uk
W: www.vobsterarchitectural.co.uk

It is the responsibility of the customer to ensure the suitability of any of these products within their project. Vobster Cast Stone Ltd. can accept no responsibility for the accuracy or suitability of any information produced and offer no warranty whatsoever in this respect. All units weigh approx. 2.4 tonnes* although this will depend on the chosen mix design - please therefore contact us for confirmation of weights. To comply with C.E.N regulations please notify us if you require lifting sockets to be incorporated into units at time of order.

KEY
 DENOTES FINISHED FACES
 DENOTES DIRECTION OF WEATHERING

SCALE 1:5 U.S.O.

TITLE
FLAT COPING (C310-F)

Drawing No. VC-CPF-01 **Rev**



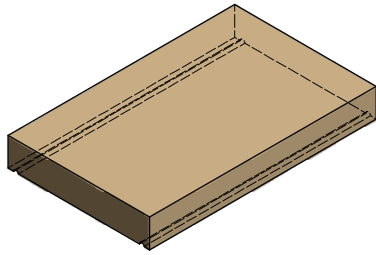

C375-F - STRAIGHT
APPROX. 39 kg

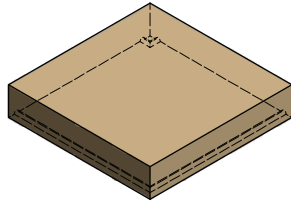

C375-FX90 - INT/EXT 90°
APPROX. 24 kg

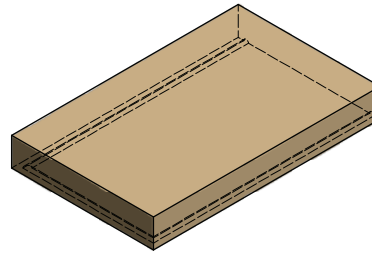

C375-FL - STOP END
APPROX. 39 kg

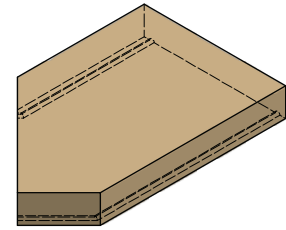

C375-FX45L - INT/EXT 45° L/H (AS DRAWN)
C375-FX45R - INT/EXT 45° R/H (HANDED)
APPROX. 32 kg

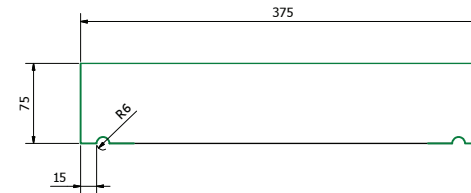
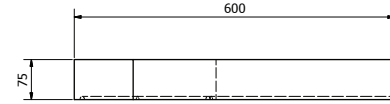
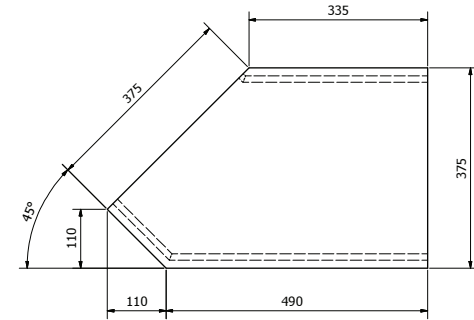
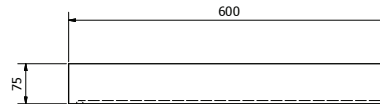
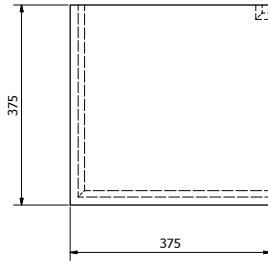
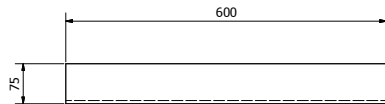

TYPICAL SECTION (1 : 2.5)

VOBSTER

ARCHITECTURAL

Vobster Architectural
Newbury Works
Coleford, Radstock
Somerset, BA3 9RX
T: +44 (0)1203 958 7058
E: enquiries@vobsterarchitectural.co.uk
W: www.vobsterarchitectural.co.uk

It is the responsibility of the customer to ensure the suitability of any of these products within their project. Vobster Call Three Ltd. can accept no responsibility for the accuracy or suitability of any information produced and offer no warranty whatsoever in this respect. All units weigh approx. 2.4 tonnes/m² although this will depend on the chosen rim design - please therefore contact us for confirmation of weights. To comply with C.E.N regulations please notify us if you require lifting sockets to be incorporated into units at time of order.

KEY
— DENOTES FINISHED FACES
→ DENOTES DIRECTION OF WEATHERING

SCALE 1:5 U.S.O.

TITLE
FLAT COPING (C375-F)

Drawing No. VC-CPF-02 **Rev**

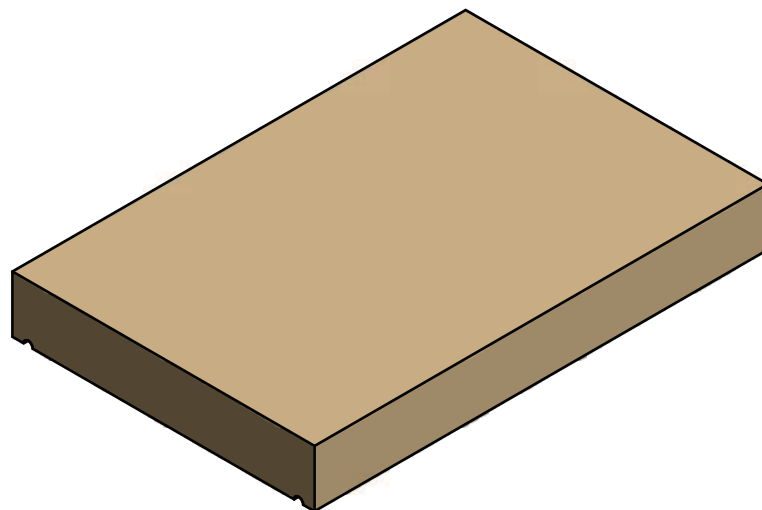

C400-F COPING

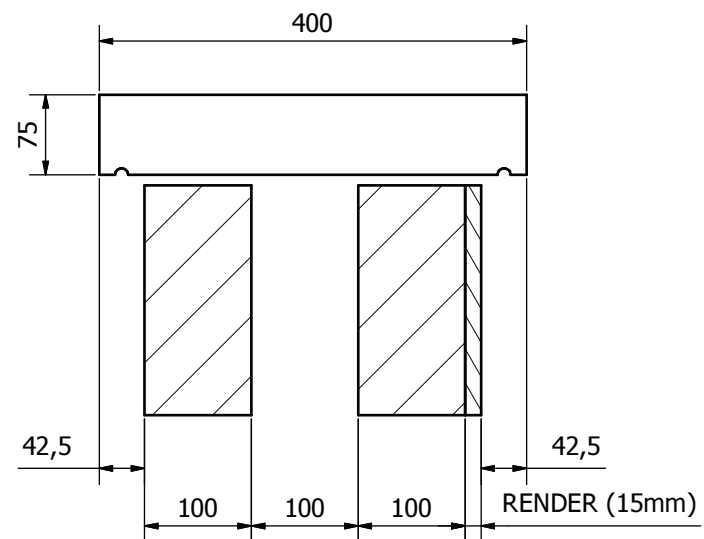

TYPICAL SECTION

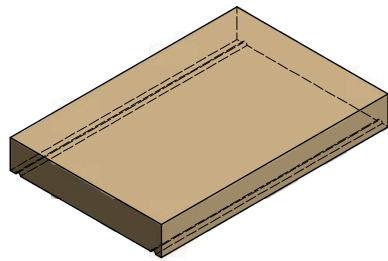

C400-F - STRAIGHT
APPROX. 41 kg

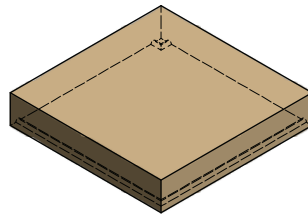

C400-FX90 - INT/EXT 90°
APPROX. 27 kg

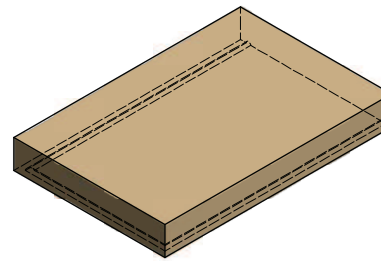

C400-FL - STOP END
APPROX. 41 kg

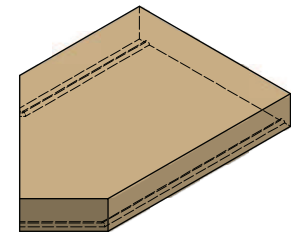

C400-FX45L - INT/EXT 45° L/H (AS DRAWN)
C400-FX45R - INT/EXT 45° R/H (HANDED)
APPROX. 33 kg

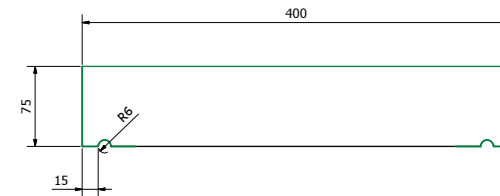
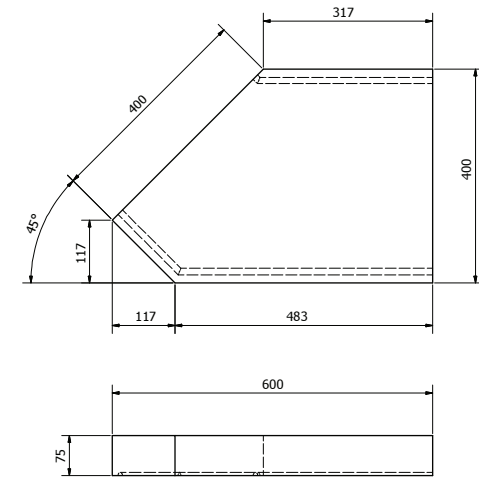
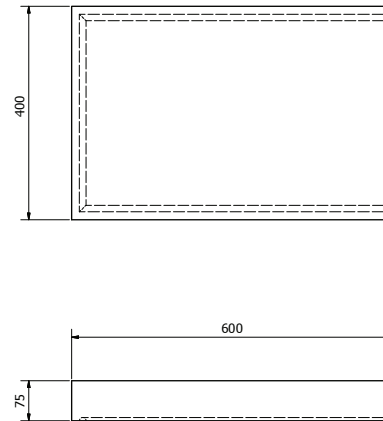
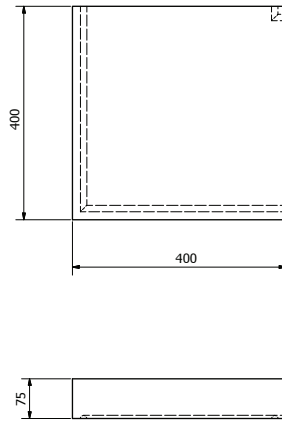
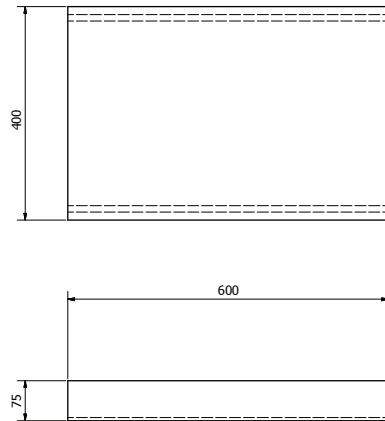

TYPICAL SECTION (1 : 2.5)

VOBSTER ARCHITECTURAL	
Vobster Architectural Newbury Works Coleford, Radstock Somerset, BA3 8RX Tel: +44 (0)1203 968 7058 Email: enquiries@vobsterarchitectural.co.uk Web: www.vobsterarchitectural.co.uk	
<small>It is the responsibility of the customer to ensure the suitability of any of these products within their project. Vobster Call Three Ltd. can accept no responsibility for the accuracy or suitability of any information produced and offer no warranty whatsoever in this respect. All units weigh approx. 2.4 tonnes/m² although this will depend on the chosen rns design - please therefore contact us for confirmation of weights. To comply with C.E.N regulations please notify us if you require lifting sockets to be incorporated into units at time of order.</small>	
KEY DENOTES FINISHED FACES DENOTES DIRECTION OF WEATHERING	SCALE 1:5 U.S.O.
TITLE FLAT COPING (C400-F)	
Drawing No. VC-CPF-03	Rev

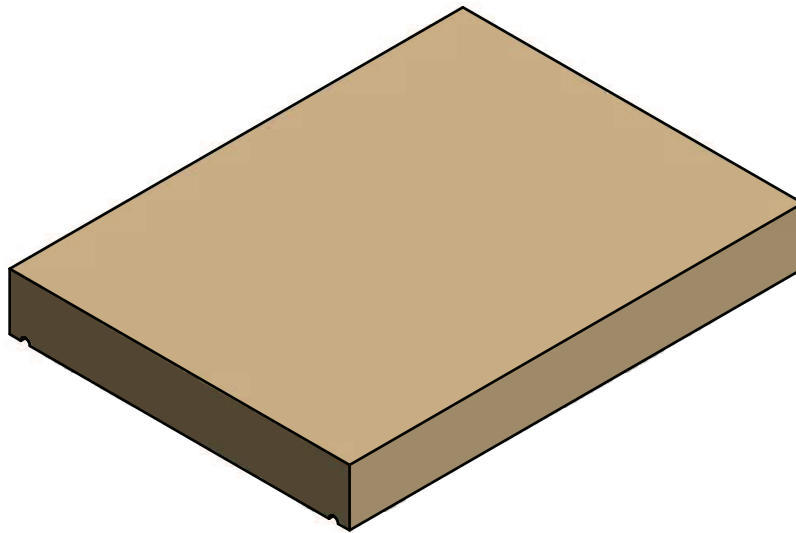

C450-F COPING

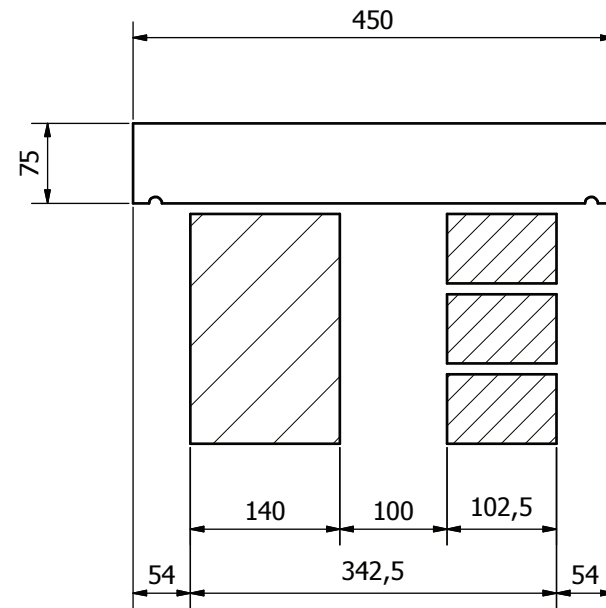

TYPICAL SECTION (342mm WALL)

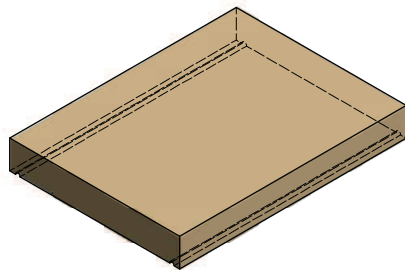

C450-F - STRAIGHT
APPROX. 46 kg

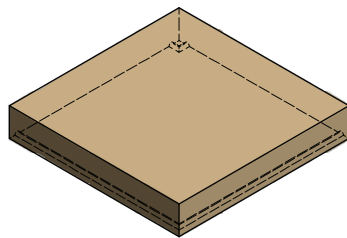

C450-FX90 - INT/EXT 90°
APPROX. 35 kg

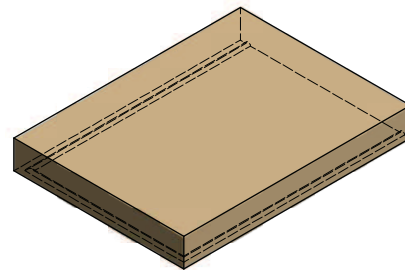

C450-FL - STOP END
APPROX. 46 kg

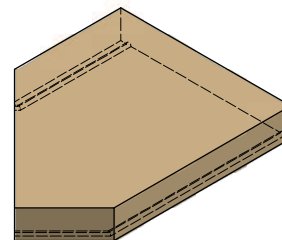

C450-FX45L - INT/EXT 45° L/H (AS DRAWN)
C450-FX45R - INT/EXT 45° R/H (HANDED)
APPROX. 36 kg

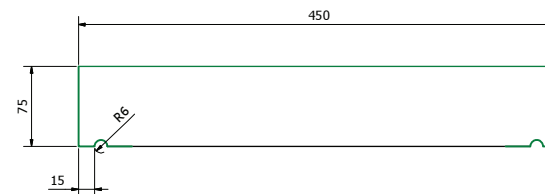
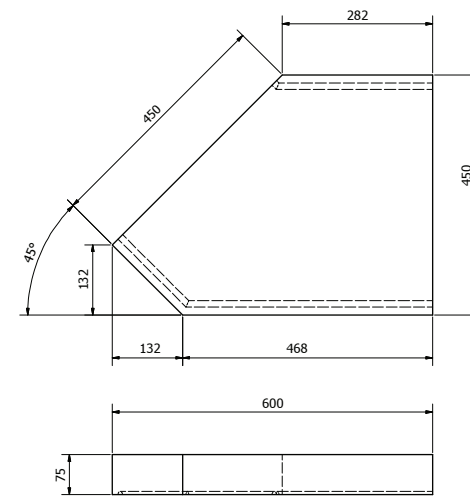
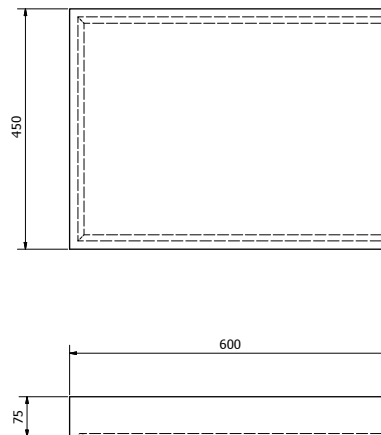
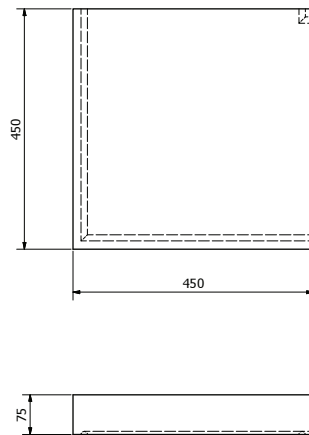
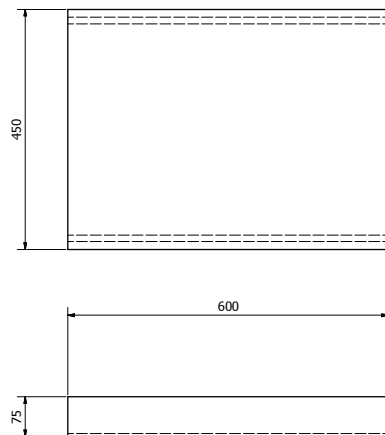

TYPICAL SECTION (1 : 2.5)

VOBSTER ARCHITECTURAL	
Vobster Architectural Newbury Works Coleford, Radstock Somerset, BA3 8RX Tel: +44 (0)203 968 7058 Email: enquiries@vobsterarchitectural.co.uk Web: www.vobsterarchitectural.co.uk	
<small>It is the responsibility of the customer to ensure the suitability of any of these products within their project. Vobster Architectural Ltd. can accept no responsibility for the accuracy or suitability of any information produced and offer no warranty whatsoever in this respect. All units weigh approx. 2.4 tonnes/m² although this will depend on the chosen mix design - please therefore contact us for confirmation of weights. To comply with CEN regulations please notify us if you require lifting sockets to be incorporated into units at time of order.</small>	
KEY DENOTES FINISHED FACES DENOTES DIRECTION OF WEATHERING	SCALE 1:5 U.S.O.
TITLE FLAT COPING (C450-F)	
Drawing No. VC-CPF-04	Rev

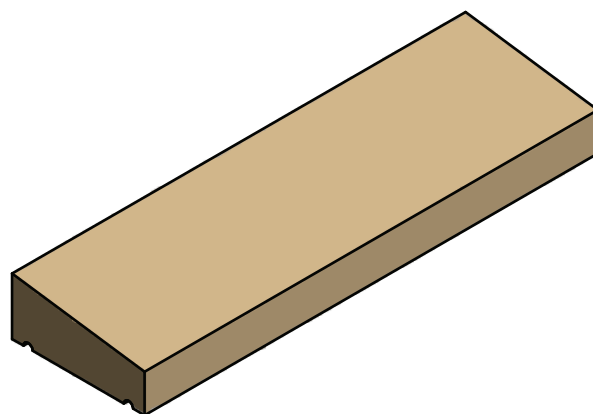

C175-1 COPING

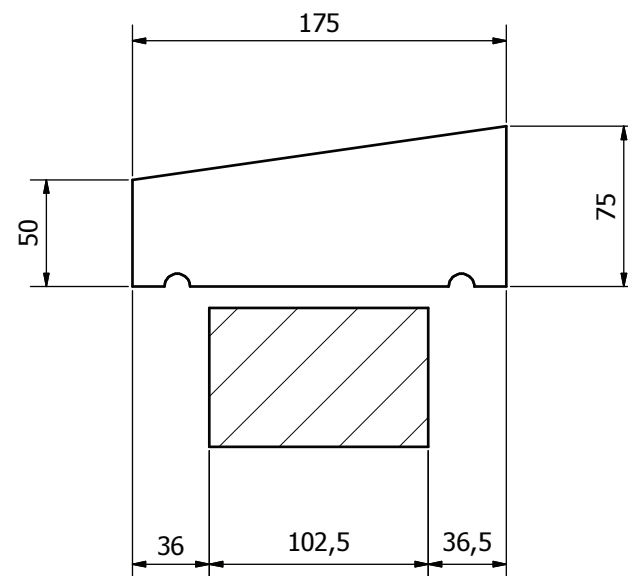

TYPICAL SECTION (102.5mm WALL)

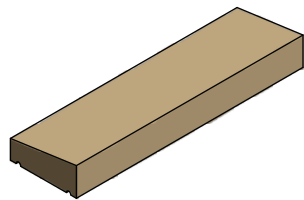

C175-1 - STRAIGHT
APPROX. 15 kg

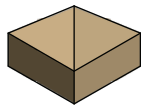

C175-1E - EXTERNAL 90°
APPROX. 5 kg

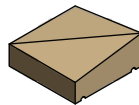

C175-1I - INTERNAL 90°
APPROX. 4 kg

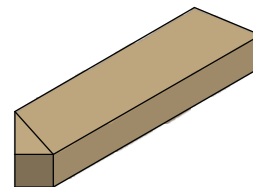

C175-1E45L - EXTERNAL 45° L/H (AS DRAWN)
C175-1E45R - EXTERNAL 45° R/H (HANDED)
APPROX. 14 kg

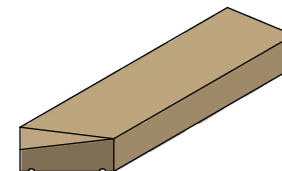

C175-1I45L - INTERNAL 45° L/H (AS DRAWN)
C175-1I45R - INTERNAL 45° R/H (HANDED)
APPROX. 14 kg

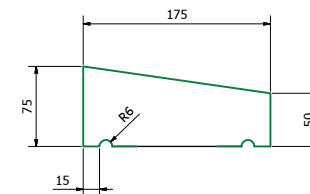
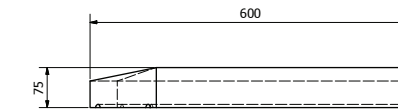
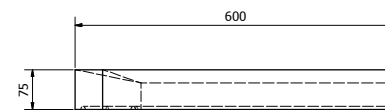
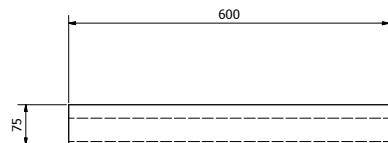
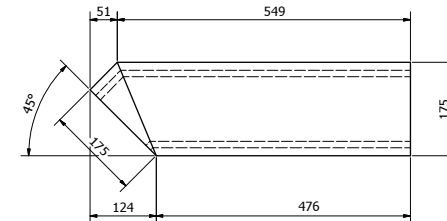
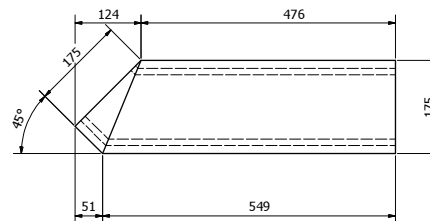
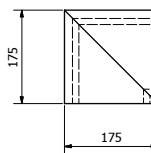
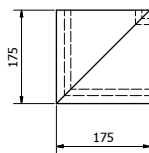
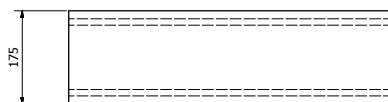

TYPICAL SECTION (1 : 2.5)

VOBSTER ARCHITECTURAL	
Vobster Architectural Newbury Works Coleford, Radstock Somerset, BA3 9RX Tel: +44 (0)203 968 7058 Email: enquiries@vobsterarchitectural.co.uk Web: www.vobsterarchitectural.co.uk	
It is the responsibility of the customer to ensure the suitability of any of these products within their project. Vobster Cast Stone Ltd. can accept no responsibility for the accuracy or suitability of any information produced and offer no warranty whatsoever in this respect. All units weigh approx. 2.4 tonnes/m² although this will depend on the chosen mix design - please therefore contact us for confirmation of weights. To comply with CEN regulations please notify us if you require lifting sockets to be incorporated into units at time of order.	
KEY	— DENOTES FINISHED FACES → DENOTES DIRECTION OF WEATHERING
SCALE	1:5 U.S.O.
TITLE 1 x WEATHERED COPING (C175-1)	
Drawing No.	VC-CP1-05
Rev	

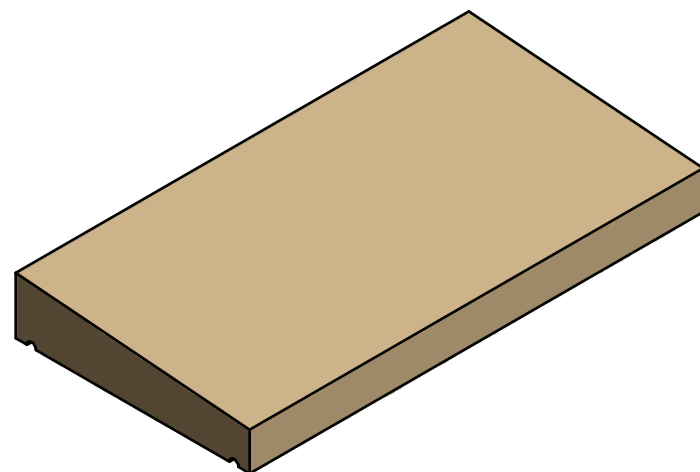

C310-1 COPING

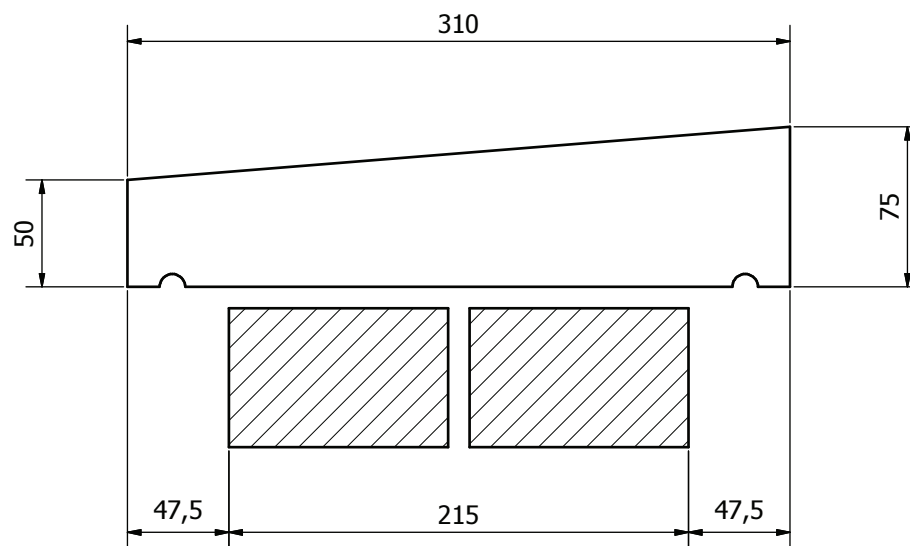

TYPICAL SECTION (215mm WALL)

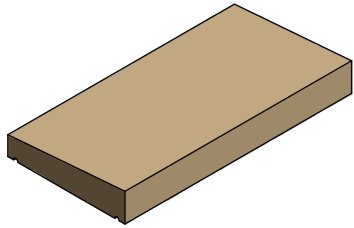

C310-1 - STRAIGHT
APPROX. 27 kg

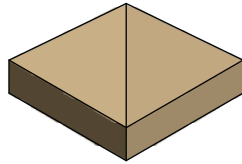

C310-1E - EXTERNAL 90°
APPROX. 15 kg

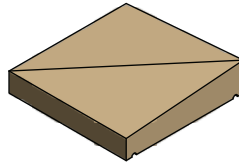

C310-1I - INTERNAL 90°
APPROX. 13 kg

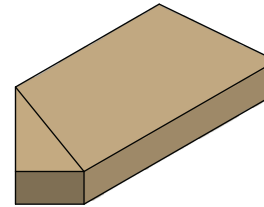

C310-1E45L - EXTERNAL 45° L/H (AS DRAWN)
C310-1E45R - EXTERNAL 45° R/H (HANDED)
APPROX. 23 kg

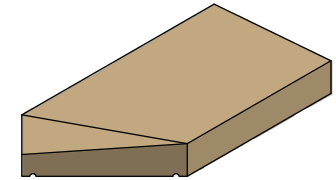

C310-1I45L - INTERNAL 45° L/H (AS DRAWN)
C310-1I45R - INTERNAL 45° R/H (HANDED)
APPROX. 22 kg

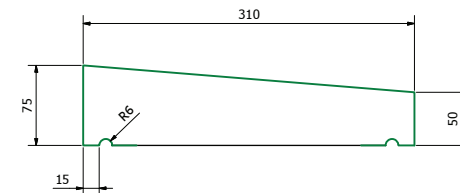
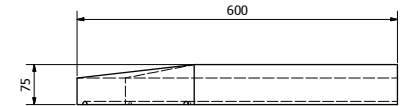
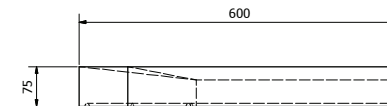
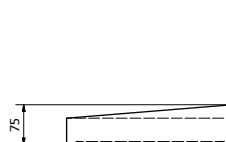
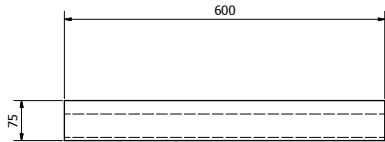
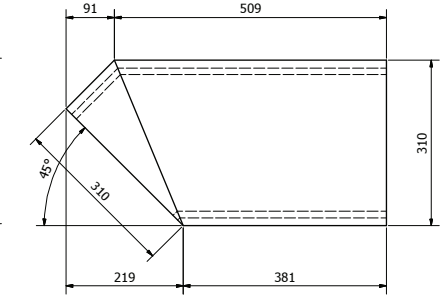
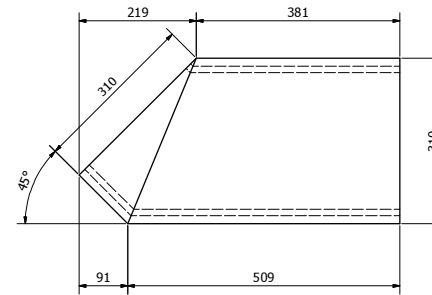
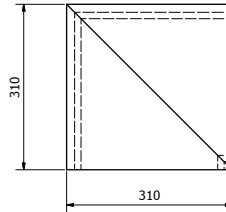
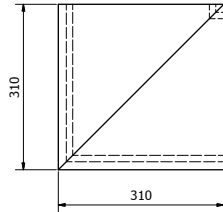

TYPICAL SECTION (1 : 2.5)

VOBSTER
ARCHITECTURAL

Vobster Architectural
Newbury Works
Coleford, Radstock
Somerset, BA3 6RX
Tel: +44 (0)203 968 7058
E: enquiries@vobsterarchitectural.co.uk
W: www.vobsterarchitectural.co.uk

It is the responsibility of the customer to ensure the suitability of any of these products within their project. Vobster Call Three Ltd can accept no responsibility for the accuracy or suitability of any information produced and offer no warranty whatsoever in this respect. All units weigh approx. 2.4 tonnes* although this will depend on the chosen mix design - please therefore contact us for confirmation of weights. To comply with CEN regulations please notify us if you require lifting sockets to be incorporated into units at time of order.

KEY
— DENOTES FINISHED FACES
→ DENOTES DIRECTION OF WEATHERING

SCALE 1:5 U.S.O.

TITLE
1 x WEATHERED COPING (C310-1)

Drawing No. VC-CP1-01 **Rev** 1

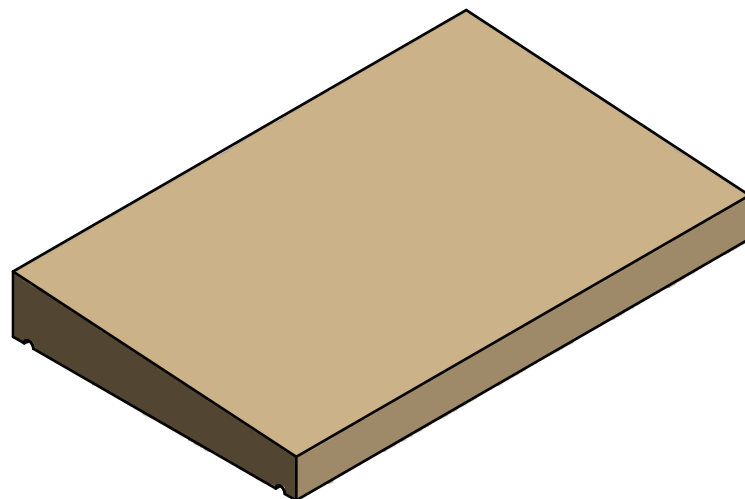

C375-1 COPING

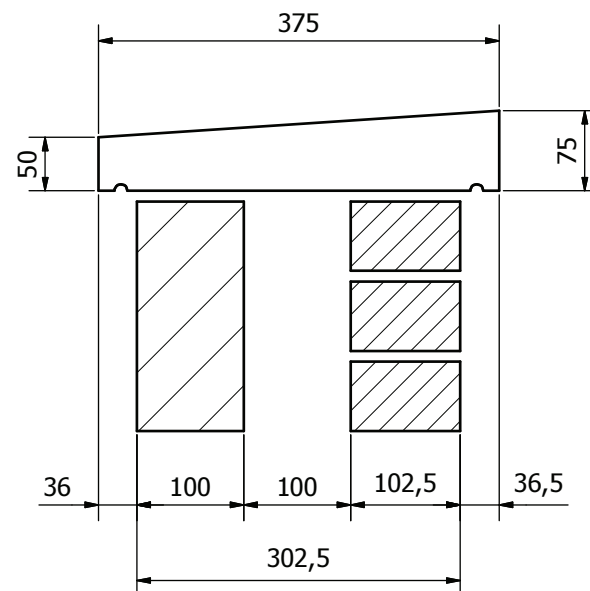

TYPICAL SECTION (302mm WALL)

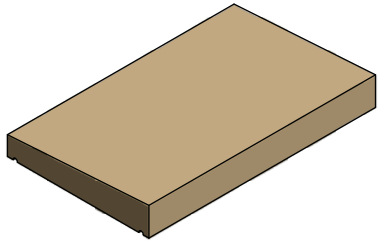

C375-1 - STRAIGHT
APPROX. 32 kg

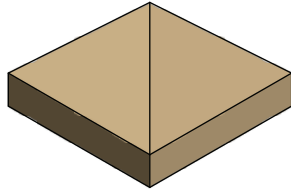

C375-1E - EXTERNAL 90°
APPROX. 21 kg

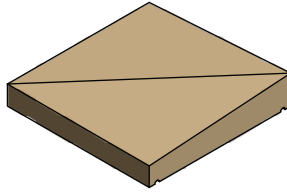

C375-1I - INTERNAL 90°
APPROX. 19 kg

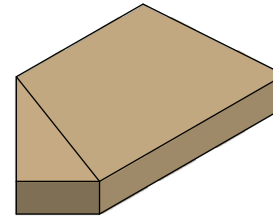

C375-1E45L - EXTERNAL 45° L/H (AS DRAWN)
C375-1E45R - EXTERNAL 45° R/H (HANDED)
APPROX. 27 kg

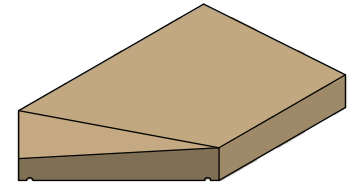

C375-1I45L - INTERNAL 45° L/H (AS DRAWN)
C375-1I45R - INTERNAL 45° R/H (HANDED)
APPROX. 26 kg

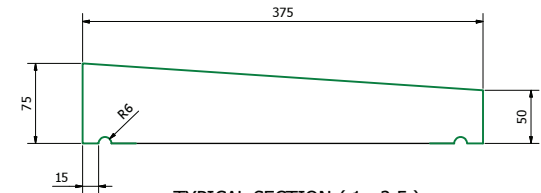
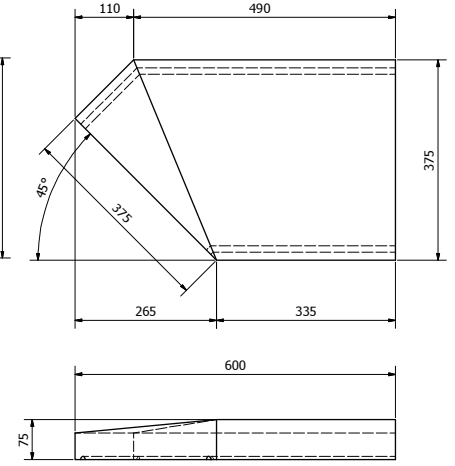
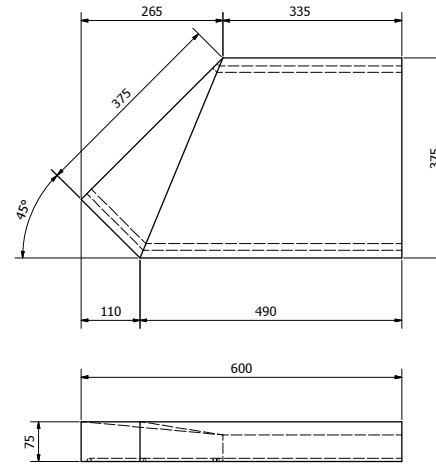
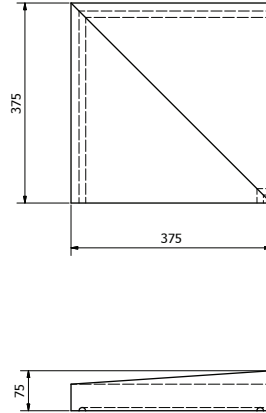
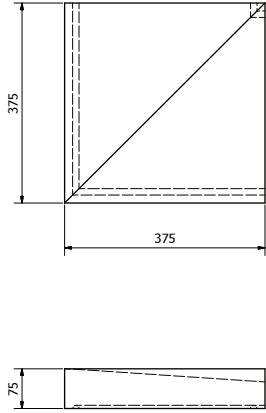
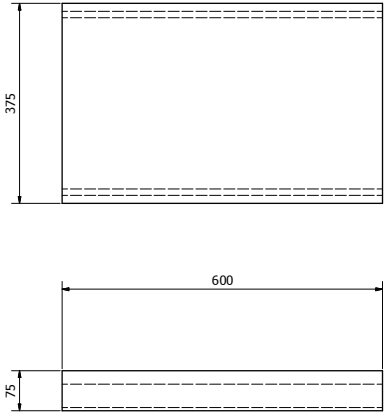

TYPICAL SECTION (1 : 2.5)

VOBSTER
ARCHITECTURAL

Vobster Architectural
Newbury Works
Coleford, Radstock
Somerset, BA3 8RX
Tel: +44 (0)203 968 7058
E: enquiries@vobsterarchitectural.co.uk
W: www.vobsterarchitectural.co.uk

It is the responsibility of the customer to ensure the suitability of any of these products within their project. Vobster Architectural cannot accept responsibility for the accuracy or suitability of any information produced and offer no warranty whatsoever in this respect. All units weigh approx. 2.4 tonnes/m² although this will depend on the chosen mix design - please therefore contact us for confirmation of weights. To comply with CEN regulations please notify us if you require lifting sockets to be incorporated into units at time of order.

KEY
— DENOTES FINISHED FACES
→ DENOTES DIRECTION OF WEATHERING

SCALE 1:5 U.S.O.

TITLE
1 x WEATHERED COPING (C375-1)

Drawing No. VC-CP1-02 **Rev** 1

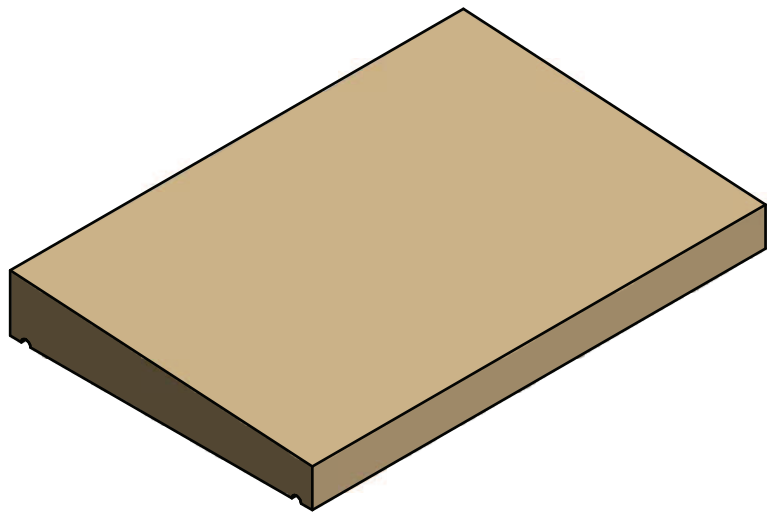

C400-1 COPING

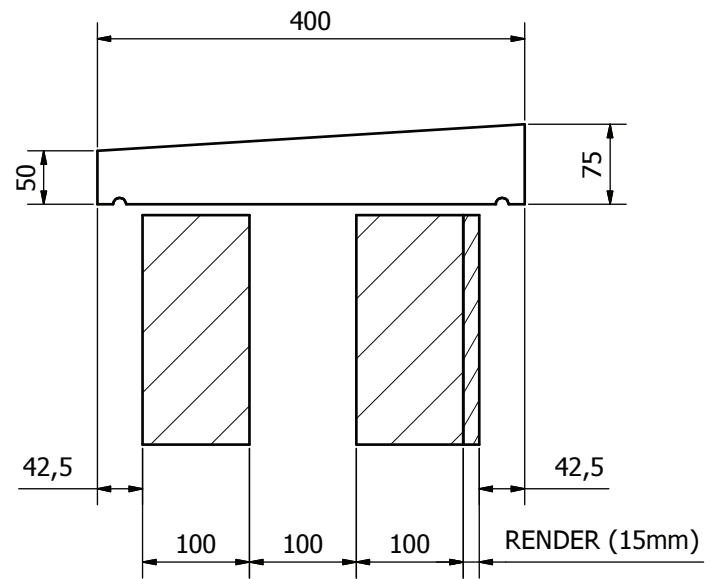

TYPICAL SECTION

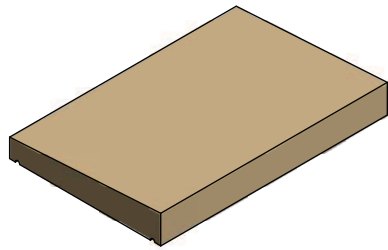

C400-1 - STRAIGHT
APPROX. 34 kg

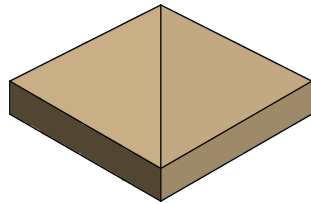

C400-1E - EXTERNAL 90°
APPROX. 24 kg

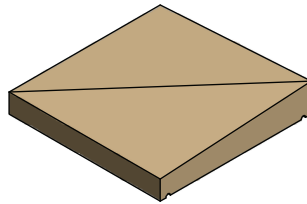

C400-1I - INTERNAL 90°
APPROX. 21 kg

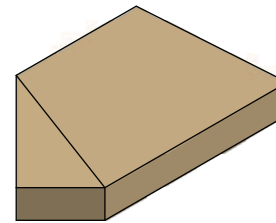

C400-1E45L - EXTERNAL 45° L/H (AS DRAWN)
C400-1E45R - EXTERNAL 45° R/H (HANDED)
APPROX. 28 kg

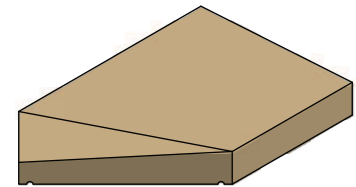

C400-1I45L - INTERNAL 45° L/H (AS DRAWN)
C400-1I45R - INTERNAL 45° R/H (HANDED)
APPROX. 27 kg

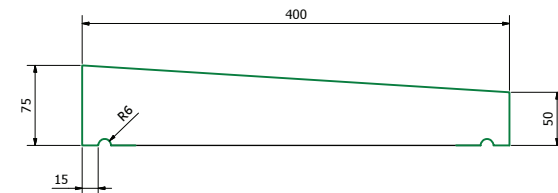
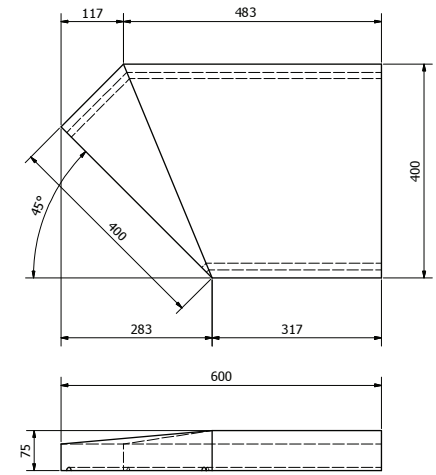
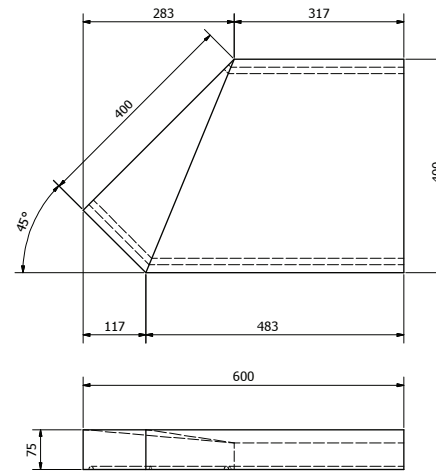
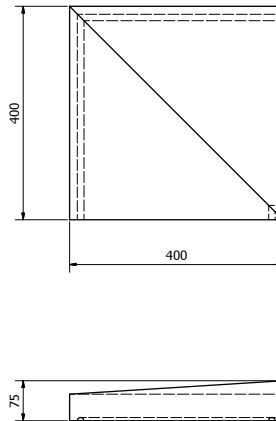
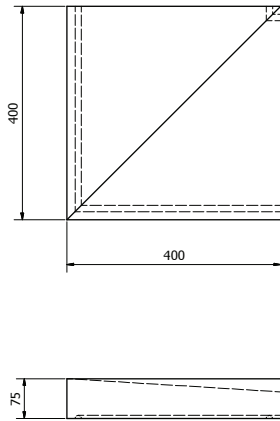
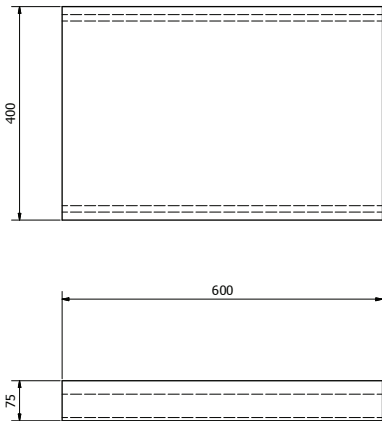

TYPICAL SECTION (1 : 2.5)

VOBSTER
ARCHITECTURAL

Vobster Architectural
Newbury Works
Coleford, Radstock
Somerset, BA3 5RX
Tel: +44 (0)203 968 7058
Email: enquiries@vobsterarchitectural.co.uk
Web: www.vobsterarchitectural.co.uk

It is the responsibility of the customer to ensure the suitability of any of these products within their project. Vobster Cast Stone Ltd. can accept no responsibility for the accuracy or suitability of any information produced and offer no warranty whatsoever in this respect. All units weigh approx. 2.4 tonnes/m² although this will depend on the chosen mix design - please therefore contact us for confirmation of weights. To comply with CEN regulations please notify us if you require lifting sockets to be incorporated into units at time of order.

KEY
— DENOTES FINISHED FACES
→ DENOTES DIRECTION OF WEATHERING

SCALE 1:5 U.S.O.

TITLE
1 x WEATHERED COPING (C400-1)

Drawing No. VC-CP1-03 **Rev** 1

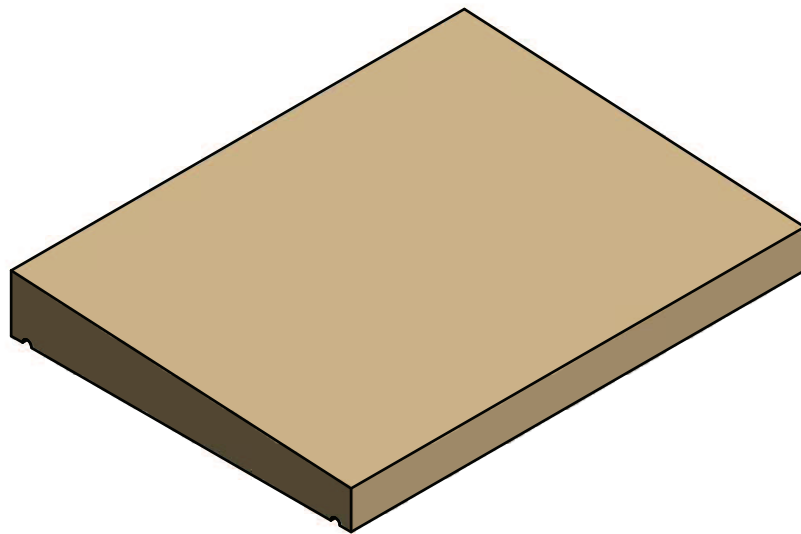

C450-1 COPING

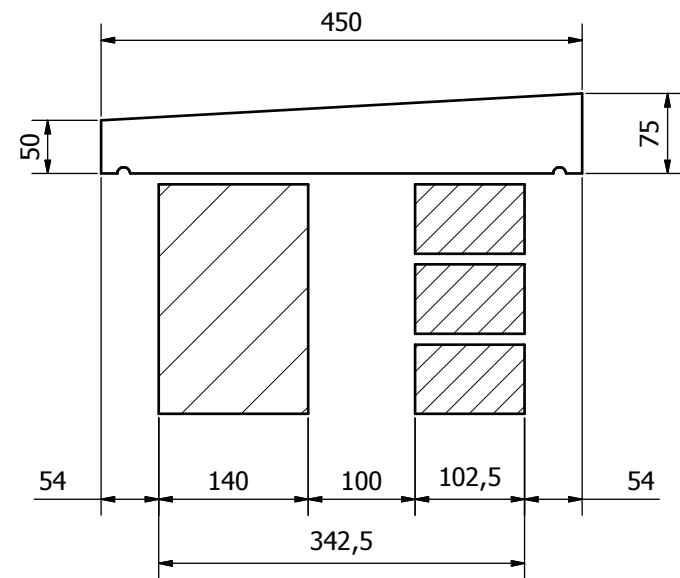

TYPICAL SECTION (342mm WALL)

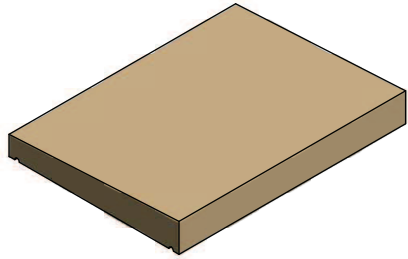

C450-1 - STRAIGHT
APPROX. 39 kg

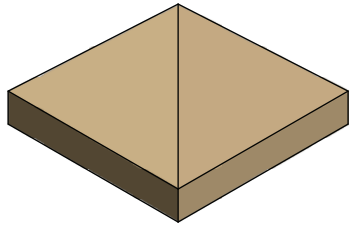

C450-1E - EXTERNAL 90°
APPROX. 31 kg

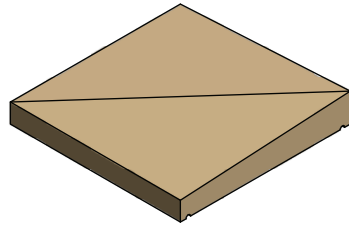

C450-1I - INTERNAL 90°
APPROX. 27 kg

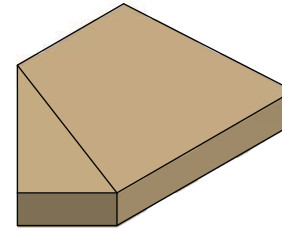

C450-1E45L - EXTERNAL 45° L/H (AS DRAWN)
C450-1E45R - EXTERNAL 45° R/H (HANDED)
APPROX. 31 kg

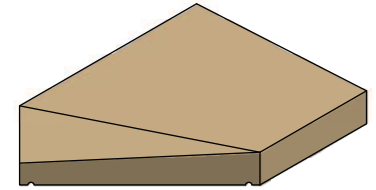

C450-1I45L - INTERNAL 45° L/H (AS DRAWN)
C450-1I45R - INTERNAL 45° R/H (HANDED)
APPROX. 29 kg

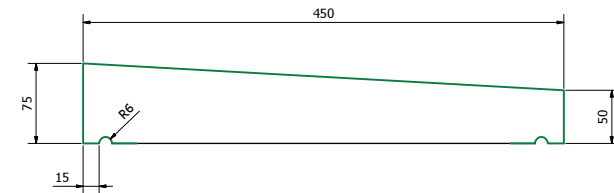
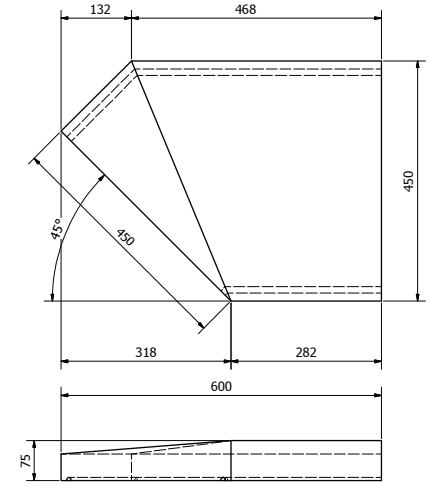
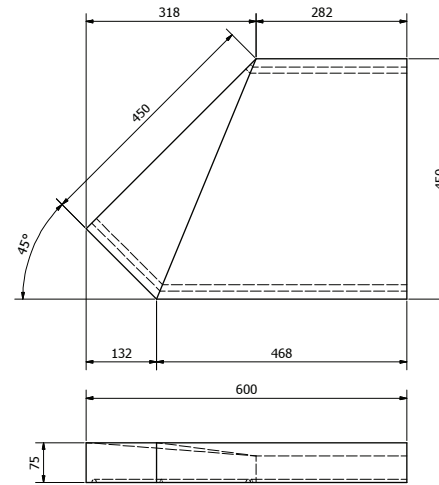
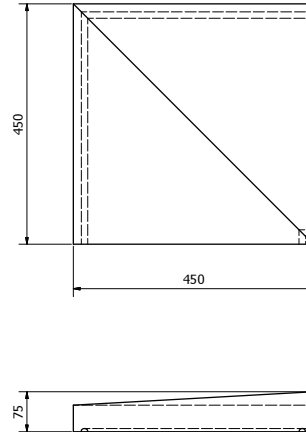
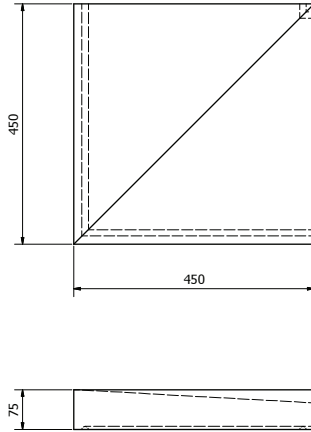
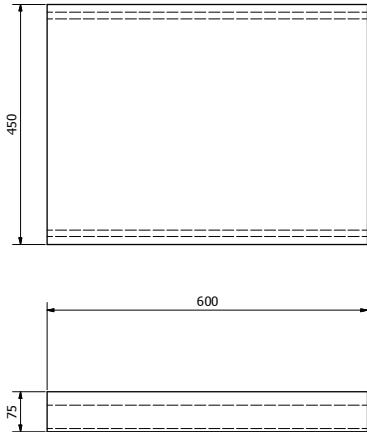

TYPICAL SECTION (1 : 2.5)

VOBSTER
ARCHITECTURAL

Vobster Architectural
Newbury Works
Coleford, Radstock
Somerset, BA3 8RX
Tel: +44 (0)203 968 7058
E: enquiries@vobsterarchitectural.co.uk
W: www.vobsterarchitectural.co.uk

It is the responsibility of the customer to ensure the suitability of any of these products within their project. Vobster Call Three Ltd. can accept no responsibility for the accuracy or suitability of any information produced and offer no warranty whatsoever in this respect. All units weigh approx. 2.4 tonnes* although this will depend on the chosen mix design - please therefore contact us for confirmation of weights. To comply with CEN regulations please notify us if you require lifting sockets to be incorporated into units at time of order.

KEY
— DENOTES FINISHED FACES
→ DENOTES DIRECTION OF WEATHERING

SCALE 1:5 U.S.O.

TITLE
1 x WEATHERED COPING (C450-1)

Drawing No. VC-CP1-04 **Rev** *

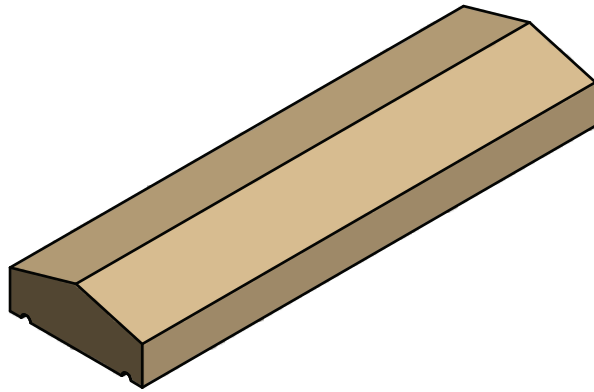

C175-2 COPING

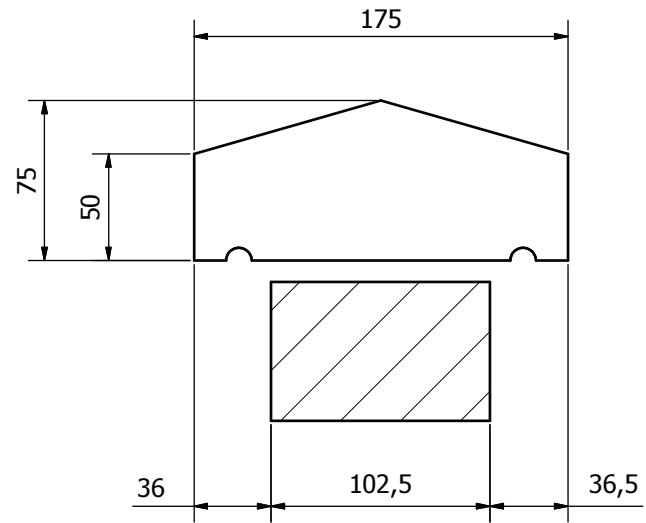

TYPICAL SECTION (102.5mm WALL)

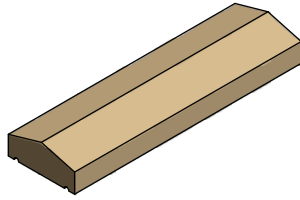

C175-2 - STRAIGHT
APPROX. 15 kg

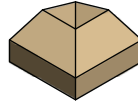

C175-2X90 - INT/EXT 90°
APPROX. 4 kg

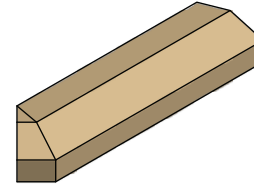

C175-2X45L - INT/EXT 45° L/H (AS DRAWN)
C175-2X45R - INT/EXT 45° R/H (HANDED)
APPROX. 14 kg

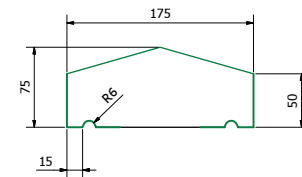
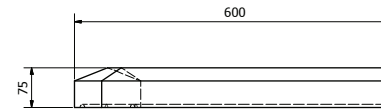
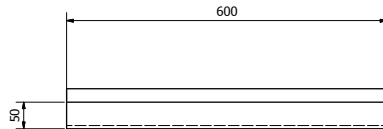
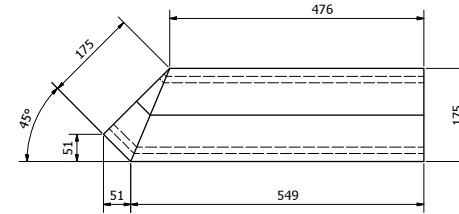
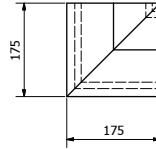
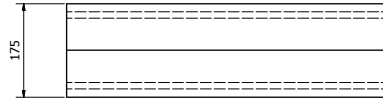

TYPICAL SECTION (1 : 2.5)

VOBSTER
ARCHITECTURAL

Vobster Architectural
Newbury Works
Coleford, Radstock
Somerset, BA3 9RX
T: +44 (0)203 968 7058
E: enquiries@vobsterarchitectural.co.uk
W: www.vobsterarchitectural.co.uk

It is the responsibility of the customer to ensure the suitability of any of these products within their project. Vobster Cast Stone Ltd. can accept no responsibility for the accuracy or suitability of any information produced and offer no warranty whatsoever in this respect. All units weigh approx. 2.4 tonnes* although this will depend on the chosen mix design - please therefore contact us for confirmation of weights. To comply with CEN regulations please notify us if you require lifting sockets to be incorporated into units at time of order.

KEY
— DENOTES FINISHED FACES
→ DENOTES DIRECTION OF WEATHERING

SCALE 1:5 U.S.O.

TITLE
2 x WEATHERED COPING (C175-2)

Drawing No. VC-CP2-05 **Rev** 1

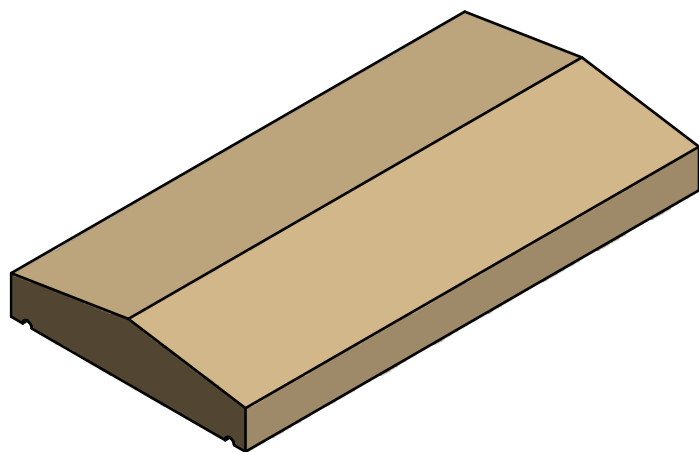

C310-2 COPING

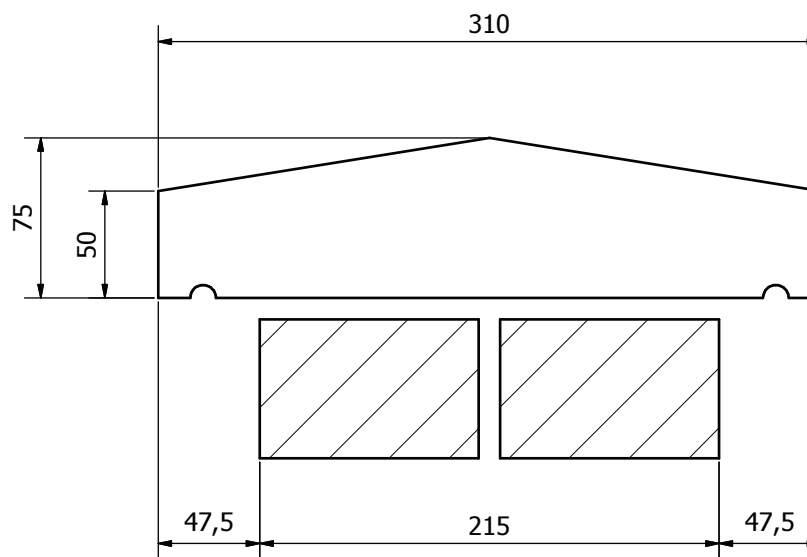

TYPICAL SECTION (215mm WALL)

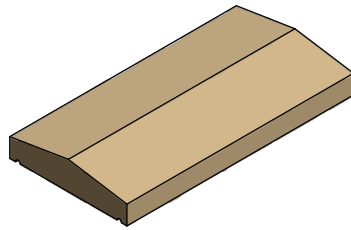

C310-2 - STRAIGHT
APPROX. 27 kg

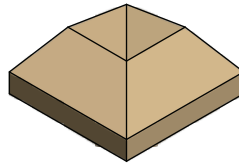

C310-2X90 - INT/EXT 90°
APPROX. 14 kg

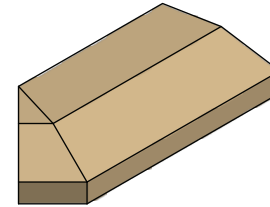

C310-2X45L - INT/EXT 45° L/H (AS DRAWN)
C310-2X45R - INT/EXT 45° R/H (HANDED)
APPROX. 23 kg

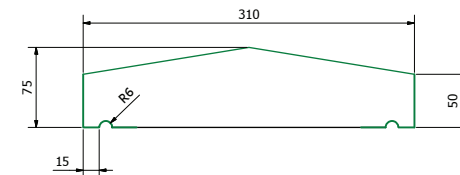
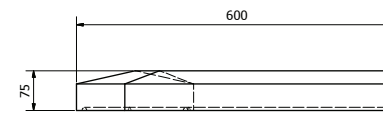
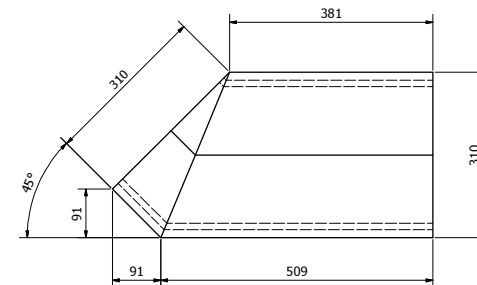
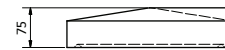
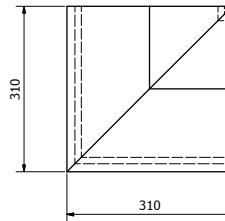
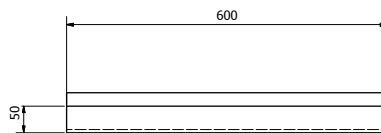
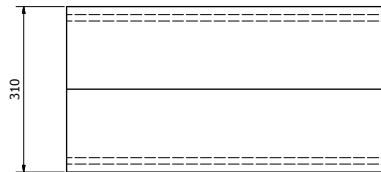

TYPICAL SECTION (1 : 2.5)

VOBSTER ARCHITECTURAL	
Vobster Architectural Newbury Works Coleford, Radstock Somerset, BA3 8RX Tel: +44 (0)1203 968 7058 Email: enquiries@vobsterarchitectural.co.uk Web: www.vobsterarchitectural.co.uk	
<small>It is the responsibility of the customer to ensure the suitability of any of these products within their project. Vobster Cast Stone Ltd. can accept no responsibility for the accuracy or suitability of any information produced and offer no warranty whatsoever in this respect. All units weigh approx. 2.4 tonnes* although this will depend on the chosen mix design - please therefore contact us for confirmation of weights. To comply with CEN regulations please notify us if you require lifting sockets to be incorporated into units at time of order.</small>	
KEY — DENOTES FINISHED FACES → DENOTES DIRECTION OF WEATHERING	SCALE 1:5 U.S.O.
TITLE 2 x WEATHERED COPING (C310-2)	
Drawing No. VC-CP2-01	Rev

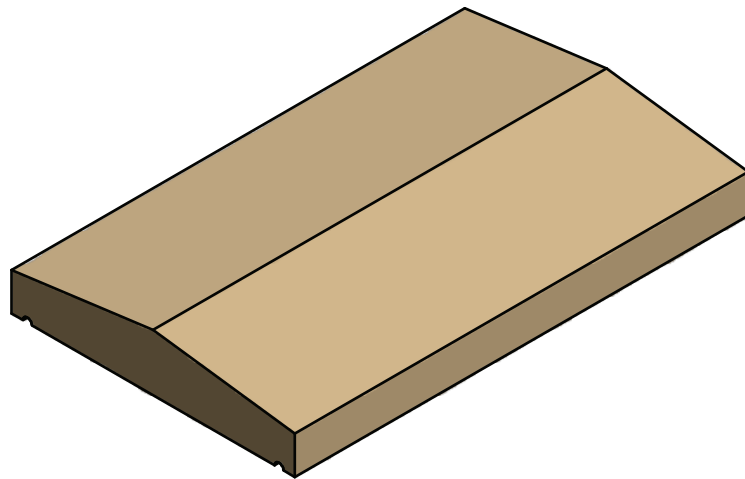

C375-2 COPING

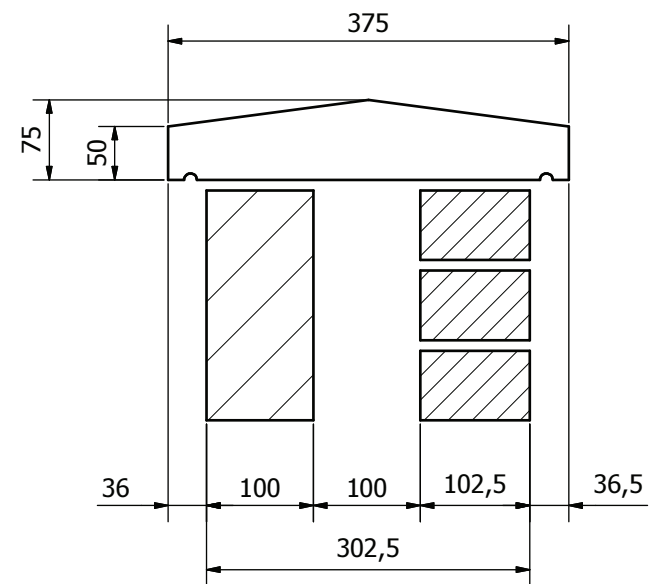

TYPICAL SECTION (302mm WALL)

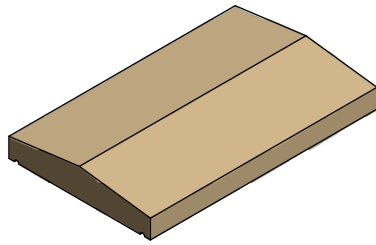

C375-2 - STRAIGHT
APPROX. 32 kg

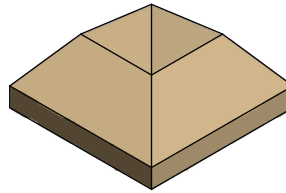

C375-2X90 - INT/EXT 90°
APPROX. 20 kg

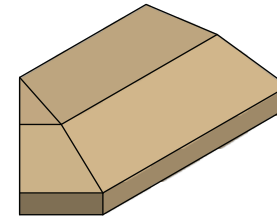

C375-2X45L - EXTERNAL 45° L/H (AS DRAWN)
C375-2X45R - EXTERNAL 45° R/H (HANDED)
APPROX. 26 kg

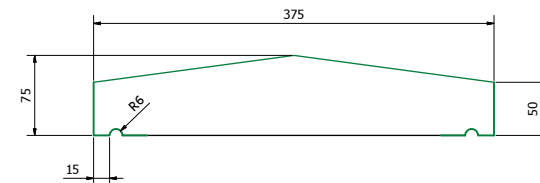
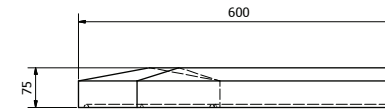
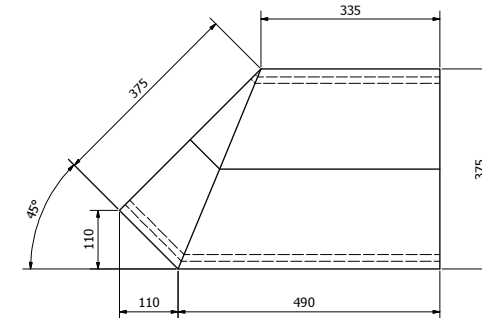
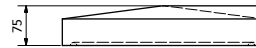
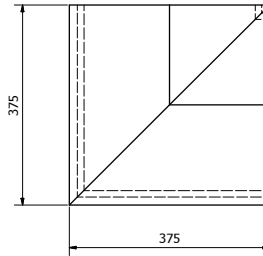
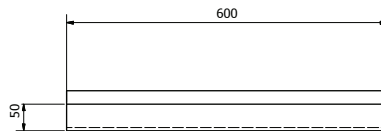
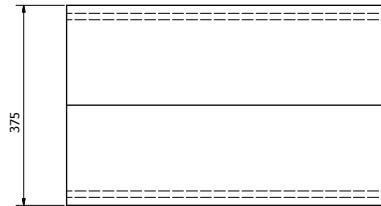

TYPICAL SECTION (1 : 2.5)

VOBSTER ARCHITECTURAL	
Vobster Architectural Newbury Works Coleford, Radstock Somerset, BA3 9RX Tel: +44 (0)203 968 7058 Email: enquiries@vobsterarchitectural.co.uk Web: www.vobsterarchitectural.co.uk	
<small>It is the responsibility of the customer to ensure the suitability of any of these products within their project. Vobster Cast Stone Ltd. can accept no responsibility for the accuracy or suitability of any information produced and offer no warranty whatsoever in this respect. All units weigh approx. 2.4 tonnes* although this will depend on the chosen mix design - please therefore contact us for confirmation of weights. To comply with CEN regulations please notify us if you require lifting sockets to be incorporated into units at time of order.</small>	
KEY DENOTES FINISHED FACES DENOTES DIRECTION OF WEATHERING	SCALE 1:5 U.S.O.
TITLE 2 x WEATHERED COPING (C375-2)	
Drawing No. VC-CP2-02	Rev

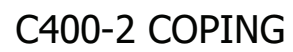

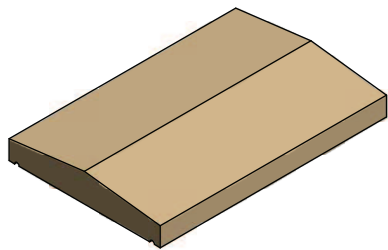

C400-2 - STRAIGHT
APPROX. 34 kg

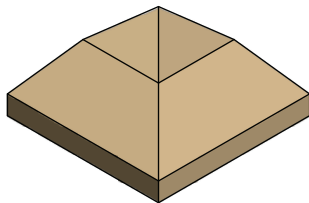

C400-2X90 - INT/EXT 90°
APPROX. 23 kg

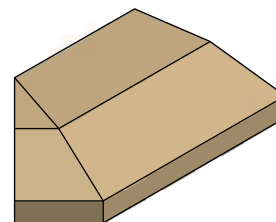

C400-2X45L - INT/EXT 45° L/H (AS DRAWN)
C400-2X45R - INT/EXT 45° R/H (HANDED)
APPROX. 28 kg

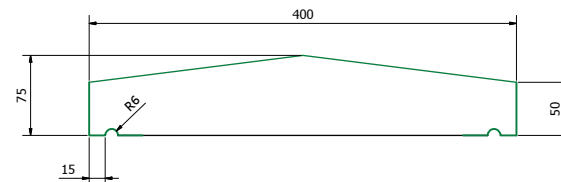
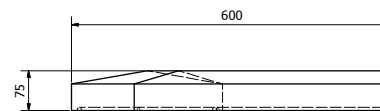
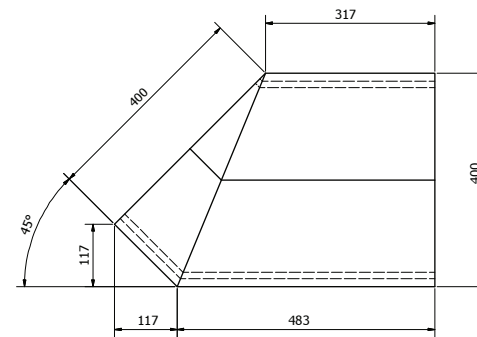
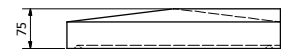
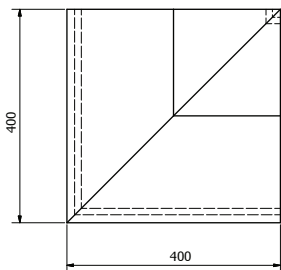
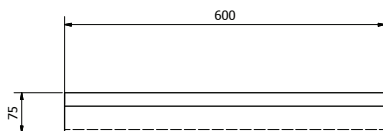
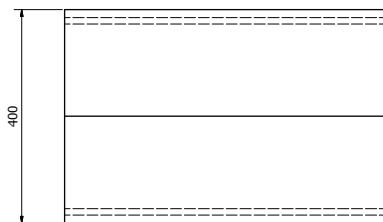

TYPICAL SECTION (1 : 2.5)

VOBSTER ARCHITECTURAL	
Vobster Architectural Newbury Works Coleford, Radstock Somerset, BA3 8RX Tel: +44 (0)203 968 7058 E: enquiries@vobsterarchitectural.co.uk W: www.vobsterarchitectural.co.uk	
It is the responsibility of the customer to ensure the suitability of any of these products within their project. Vobster Cast Stone Ltd can accept no responsibility for the accuracy or suitability of any information produced and offer no warranty whatsoever in this respect. All units weigh approx. 2.4 tonnes* although this will depend on the chosen mix design - please therefore contact us for confirmation of weights. To comply with CEN regulations please notify us if you require lifting sockets to be incorporated into units at time of order.	
KEY DENOTES FINISHED FACES DENOTES DIRECTION OF WEATHERING	SCALE 1:5 U.S.O.
TITLE 2 x WEATHERED COPING (C400-2)	
Drawing No. VC-CP2-03	Rev

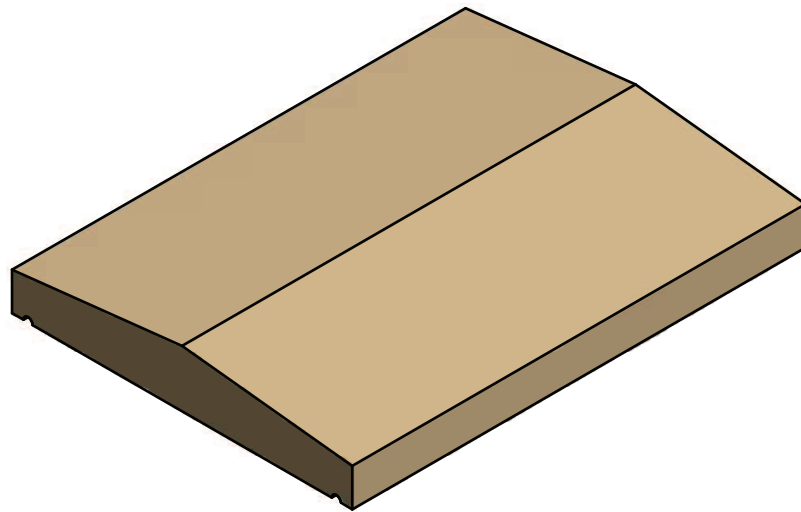

C450-2 COPING

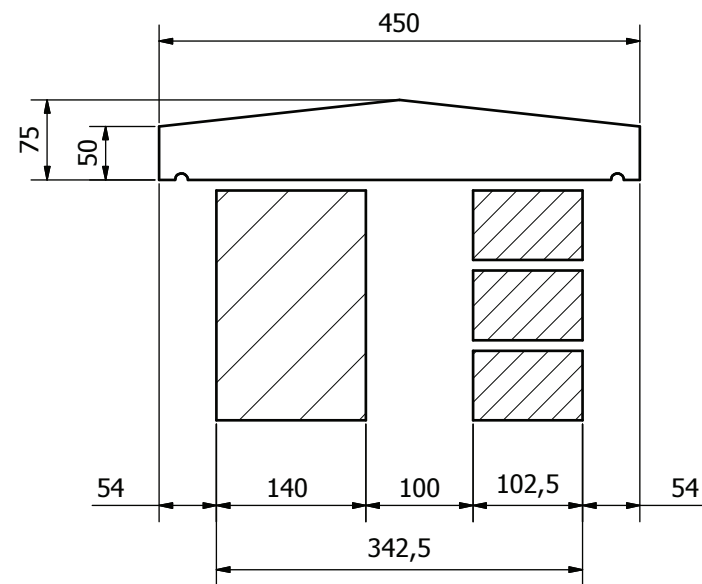

TYPICAL SECTION (342mm WALL)

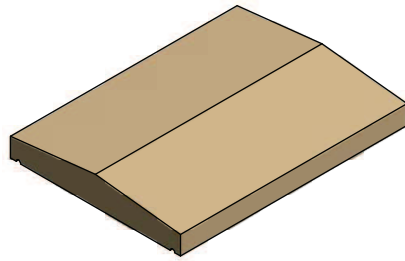

C450-2 - STRAIGHT
APPROX. 39 kg

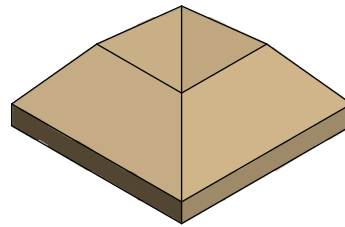
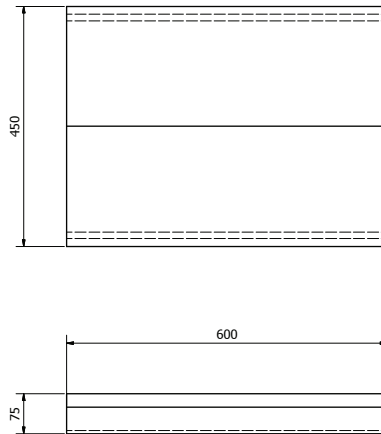

C450-2X90 - INT/EXT 90°
APPROX. 29 kg

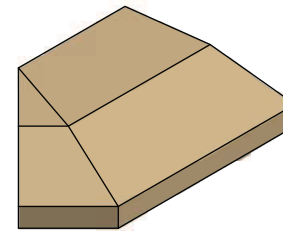
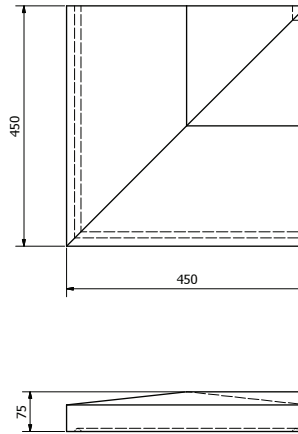

C450-2X45L - INT/EXT 45° L/H (AS DRAWN)
C450-2X45R - INT/EXT 45° R/H (HANDED)
APPROX. 30 kg

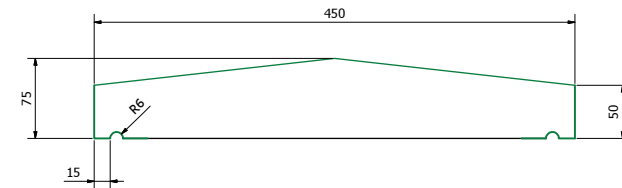
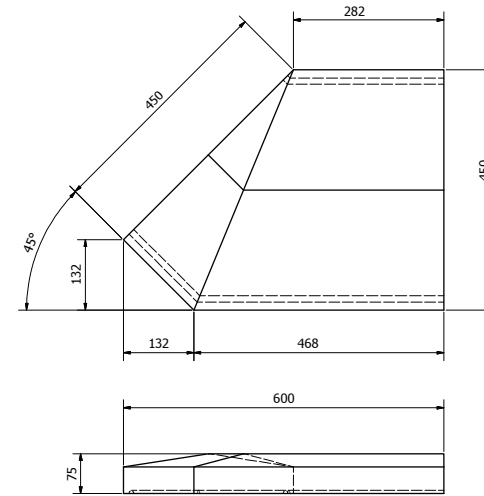

TYPICAL SECTION (1 : 2.5)

VOBSTER ARCHITECTURAL	
Vobster Architectural Newbury Works Coleford, Radstock Somerset, BA3 5RX Tel: +44 (0)203 958 7058 Email: enquiries@vobsterarchitectural.co.uk Web: www.vobsterarchitectural.co.uk	
<small>It is the responsibility of the customer to ensure the suitability of any of these products within their project. Vobster Cast Stone Ltd. can accept no responsibility for the accuracy or suitability of any information produced and offer no warranty whatsoever in this respect. All units weigh approx. 2.4 tonnes* although this will depend on the chosen mix design - please therefore contact us for confirmation of weights. To comply with CEN regulations please notify us if you require lifting sockets to be incorporated into units at time of order.</small>	
KEY DENOTES FINISHED FACES DENOTES DIRECTION OF WEATHERING	SCALE 1:5 U.S.O.
TITLE 2 x WEATHERED COPING (C450-2)	
Drawing No. VC-CP2-04	Rev

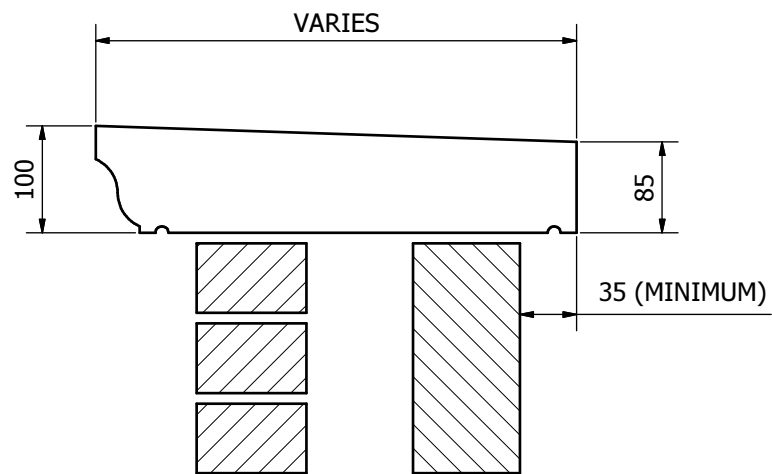

ONCE WEATHERED COPING

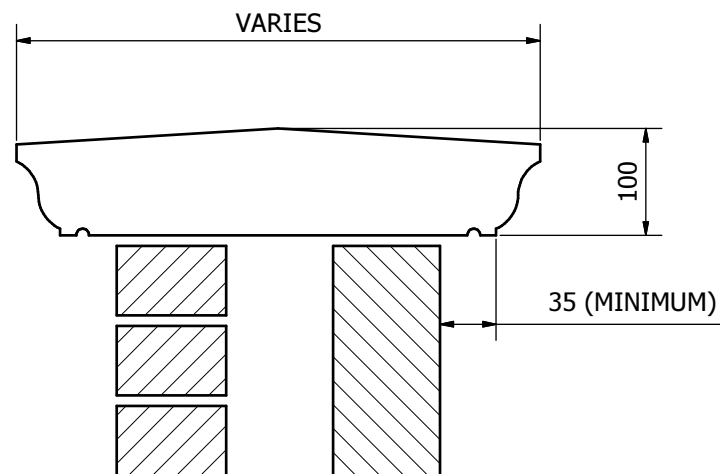

TWICE WEATHERED COPING

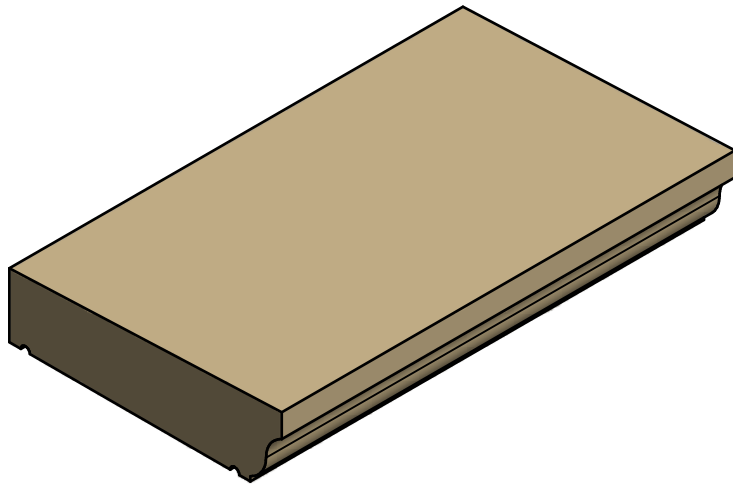

MC360-1 COPING

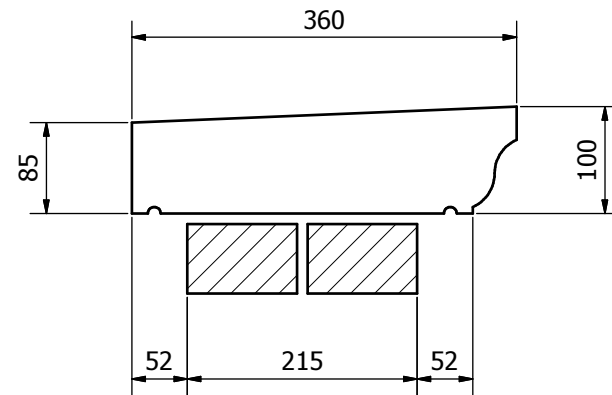

TYPICAL SECTION (215mm WALL)

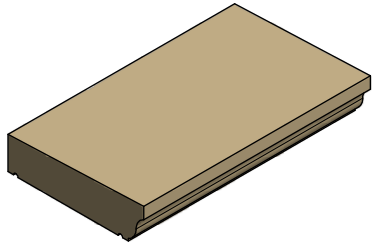

MC360-1 - STRAIGHT
APPROX. 44 kg

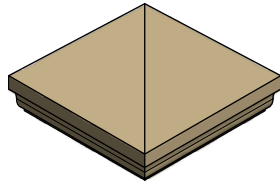

MC360-1E - EXTERNAL 90°
APPROX. 26 kg

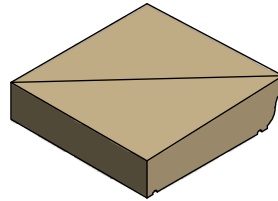

MC360-1I - INTERNAL 90°
APPROX. 27 kg

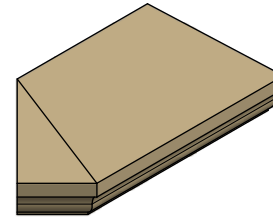

MC360-1E45L - EXTERNAL 45° L/H (AS DRAWN)
MC360-1E45R - EXTERNAL 45° R/H (HANDED)
APPROX. 36 kg

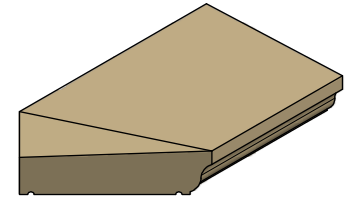

MC360-1I45L - INTERNAL 45° L/H (AS DRAWN)
MC360-1I45R - INTERNAL 45° R/H (HANDED)
APPROX. 36 kg

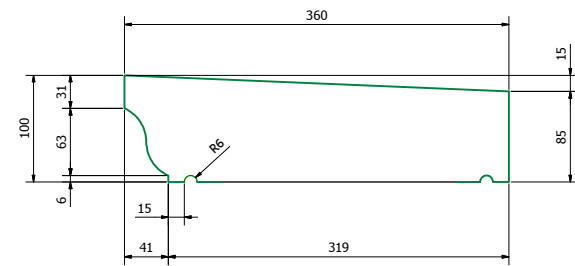
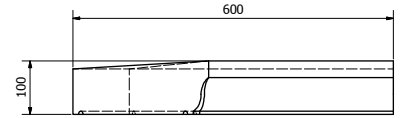
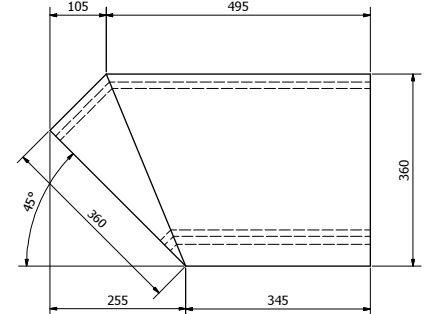
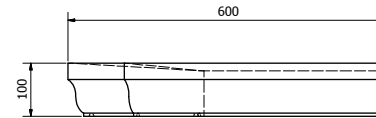
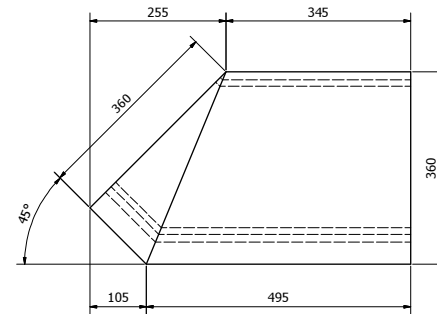
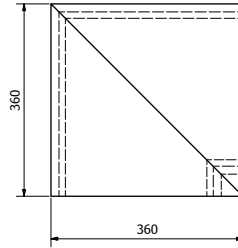
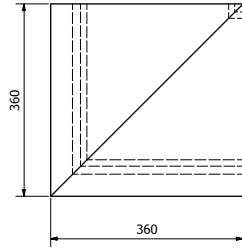
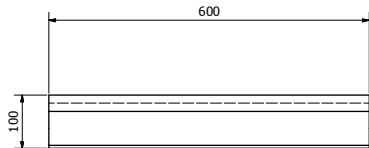
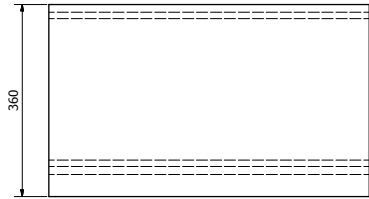

TYPICAL SECTION (1 : 2.5)

VOBSTER ARCHITECTURAL	
Vobster Architectural Newbury Works Coleford, Radstock Somerset, BA3 9RX Tel: +44 (0)203 968 7058 E: enquiries@vobsterarchitectural.co.uk W: www.vobsterarchitectural.co.uk	
<small>It is the responsibility of the customer to ensure the suitability of any of these products within their project. Vobster Call Three Ltd. can accept no responsibility for the accuracy or suitability of any information produced and offer no warranty whatsoever in this respect. All units weigh approx. 2.4 tonnes/m² although this will depend on the chosen rim design - please therefore contact us for confirmation of weights. To comply with CEN regulations please notify us if you require lifting sockets to be incorporated into units at time of order.</small>	
KEY — DENOTES FINISHED FACES — DENOTES DIRECTION OF WEATHERING	SCALE 1:5 U.S.O.
TITLE 1 x WEATHERED COPING (MC360-1)	
Drawing No. VC-MCP1-01 Rev	

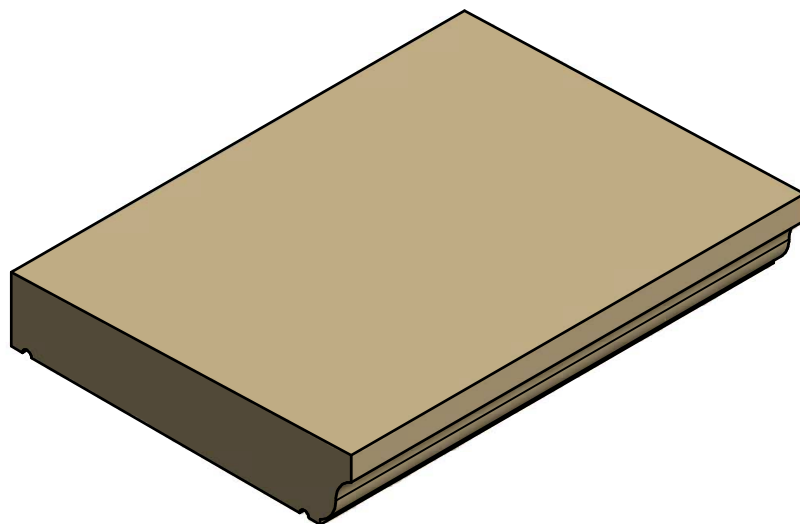

MC450-1 COPING (1:5)

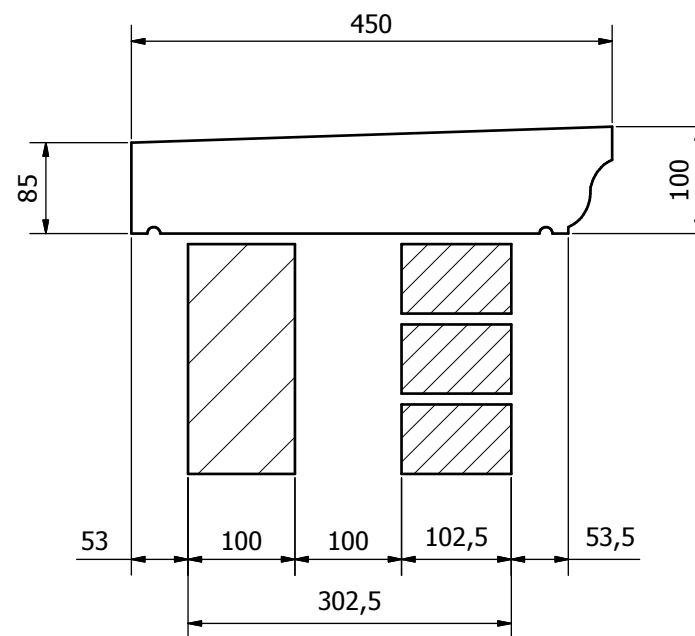

TYPICAL SECTION (302mm WALL)

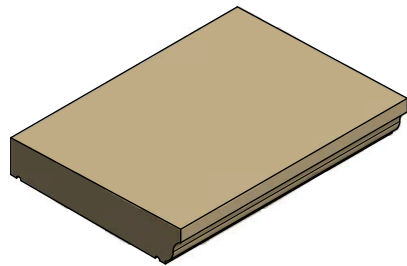

MC450-1 - STRAIGHT
APPROX. 55 kg

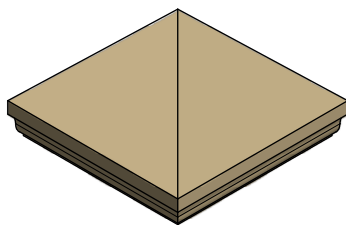

MC450-1E - EXTERNAL 90°
APPROX. 41 kg

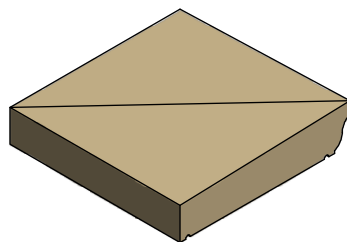

MC450-1I - INTERNAL 90°
APPROX. 42 kg

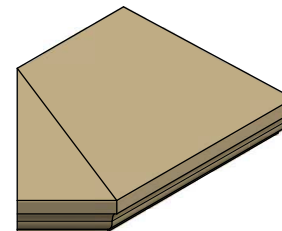

MC450-1E45L - EXTERNAL 45° L/H (AS DRAWN)
MC450-1E45R - EXTERNAL 45° R/H (HANDED)
APPROX. 43 kg

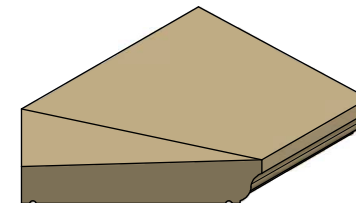

MC450-1I45L - INTERNAL 45° L/H (AS DRAWN)
MC450-1I45R - INTERNAL 45° R/H (HANDED)
APPROX. 43 kg

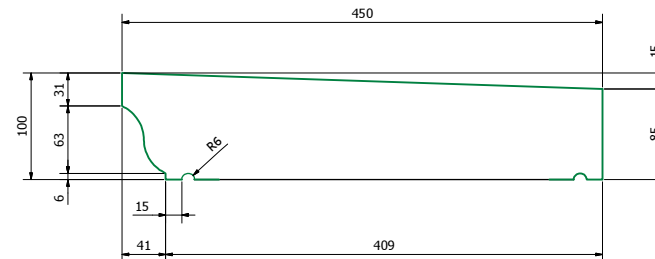
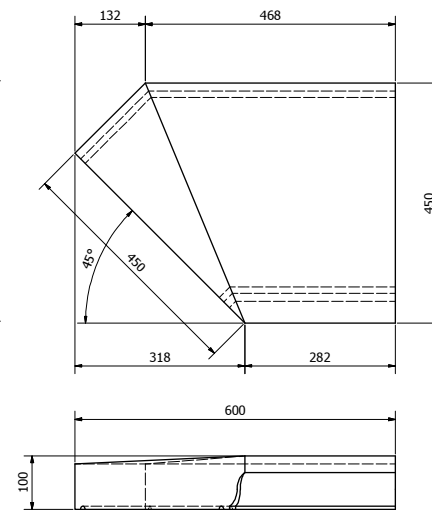
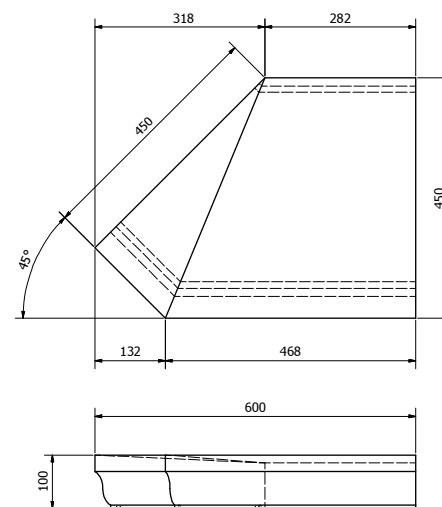
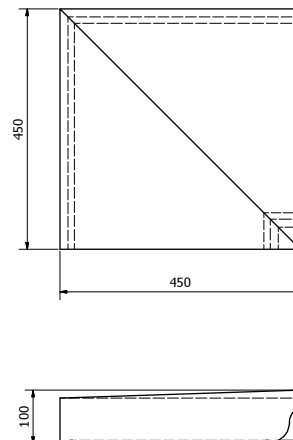
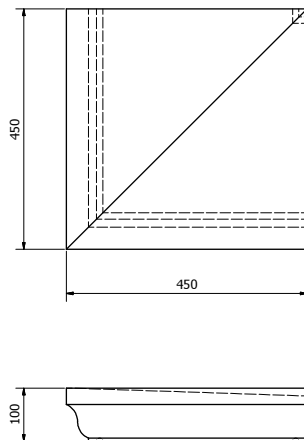
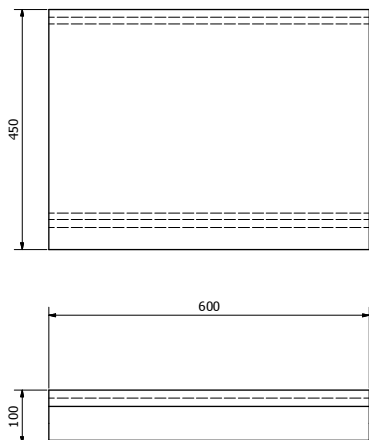

TYPICAL SECTION (1 : 2.5)

VOBSTER
ARCHITECTURAL

Vobster Architectural
Newbury Works
Coleford, Radstock
Somerset, BA3 8RX
Tel: +44 (0)203 968 7058
Email: enquiries@vobsterarchitectural.co.uk
Web: www.vobsterarchitectural.co.uk

It is the responsibility of the customer to ensure the suitability of any of these products within their project. Vobster Cast Stone Ltd. can accept no responsibility for the accuracy or suitability of any information produced and offer no warranty whatsoever in this respect. All units weigh approx. 2.4 tonnes/m² although this will depend on the chosen mix design - please therefore contact us for confirmation of weights. To comply with CEN regulations please notify us if you require lifting sockets to be incorporated into units at time of order.

KEY
— DENOTES FINISHED FACES
→ DENOTES DIRECTION OF WEATHERING

SCALE 1:5 U.S.O.

TITLE
1 x WEATHERED COPING (MC450-1)

Drawing No. VC-MCP1-02 **Rev** 0

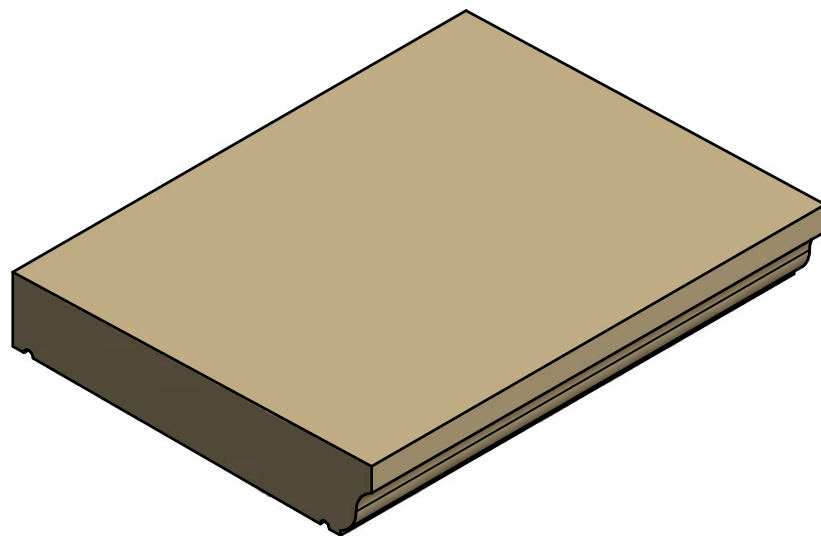

MC475-1 COPING

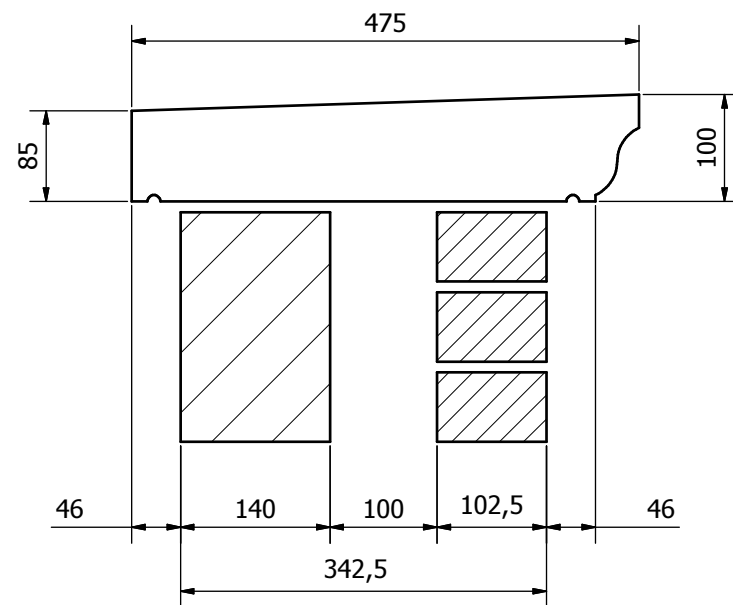

TYPICAL SECTION (342mm WALL)

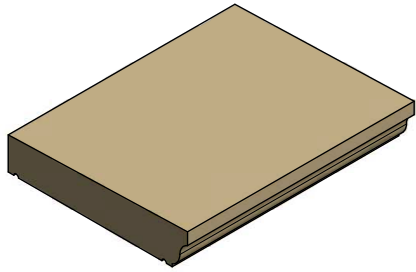

MC475-1 - STRAIGHT
APPROX. 58 kg

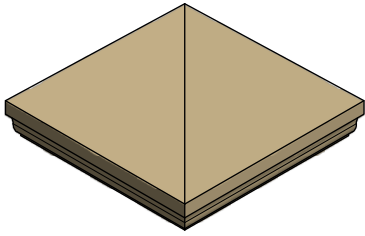

MC475-1E - EXTERNAL 90°
APPROX. 46 kg

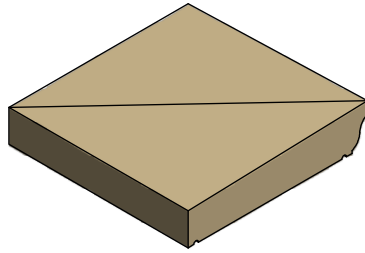

MC475-1I - INTERNAL 90°
APPROX. 46 kg

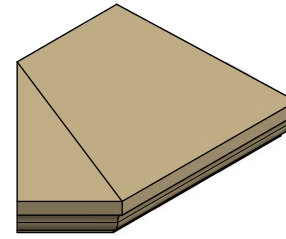

MC475-1E45L - EXTERNAL 45° L/H (AS DRAWN)
MC475-1E45R - EXTERNAL 45° R/H (HANDED)
APPROX. 45 kg

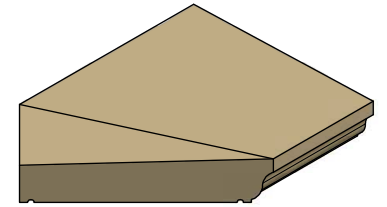

MC475-1I45L - INTERNAL 45° L/H (AS DRAWN)
MC475-1I45R - INTERNAL 45° R/H (HANDED)
APPROX. 45 kg

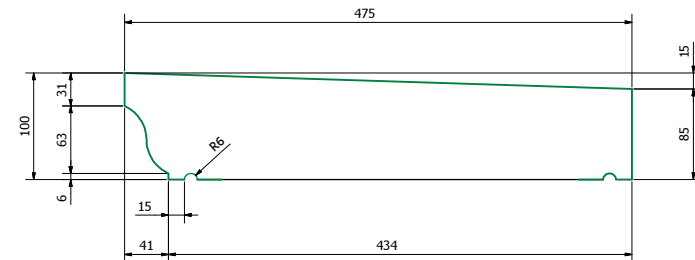
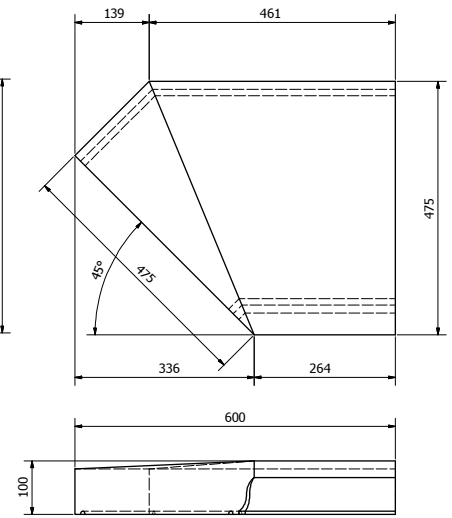
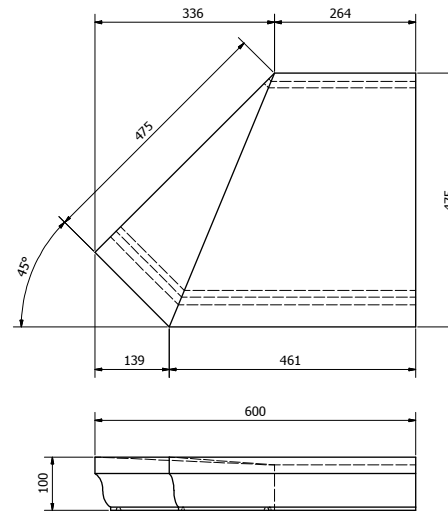
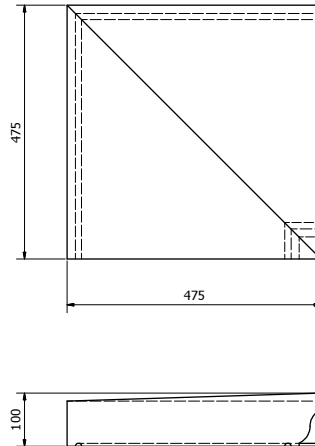
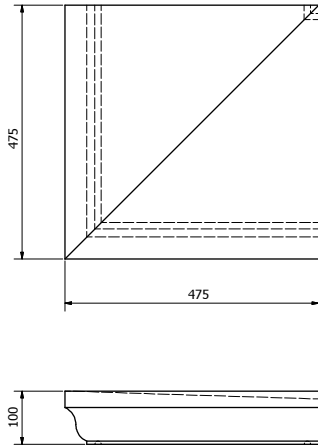
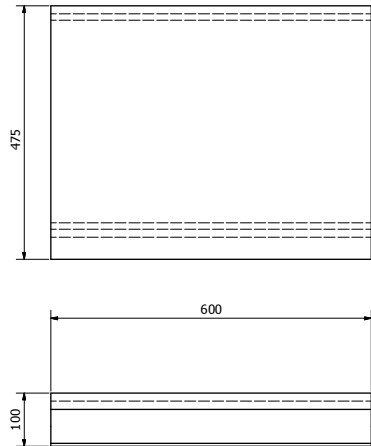

TYPICAL SECTION (1 : 2.5)

VOBSTER
ARCHITECTURAL

Vobster Architectural
Newbury Works
Coleford, Radstock
Somerset, BA3 5RX
Tel: +44 (0)203 968 7058
E: enquiries@vobsterarchitectural.co.uk
W: www.vobsterarchitectural.co.uk

It is the responsibility of the customer to ensure the suitability of any of these products within their project.
Vobster Architectural cannot accept responsibility for the accuracy or suitability of any information produced and offer no warranty whatsoever in this respect. All units weigh approx. 2.4 tonnes/m² although this will depend on the chosen mix design - please therefore contact us for confirmation of weights.
To comply with CEN regulations please notify us if you require lifting sockets to be incorporated into units at time of order.

KEY
— DENOTES FINISHED FACES
→ DENOTES DIRECTION OF WEATHERING

SCALE 1:5 U.S.O.

TITLE
1 x WEATHERED COPING (MC475-1)

Drawing No. VC-MCP1-03 **Rev** 1

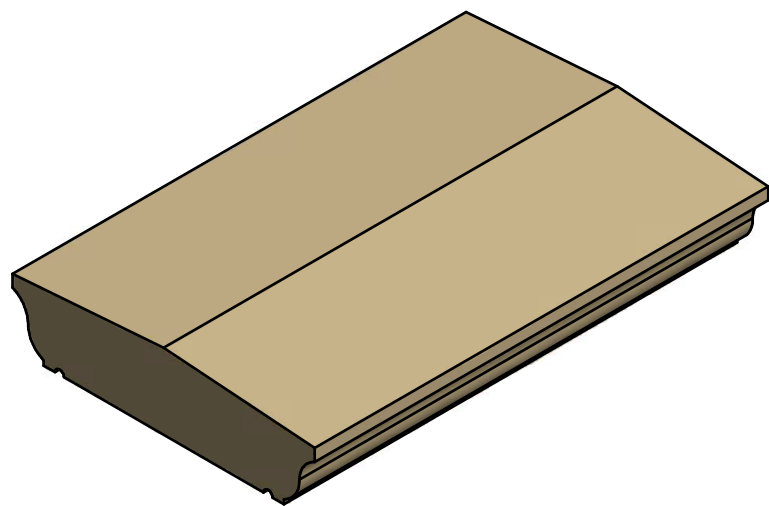

MC400-2 COPING

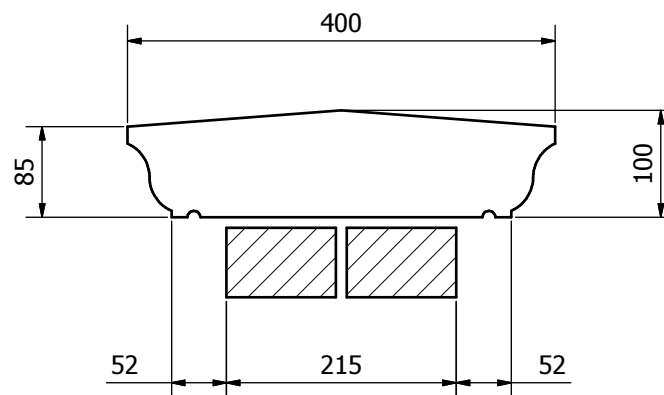

TYPICAL SECTION (215mm WALL)

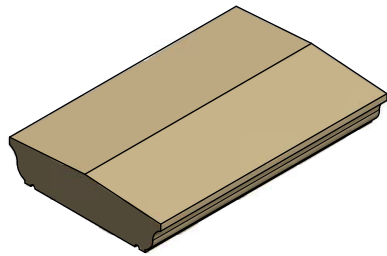

MC400-2 - STRAIGHT
APPROX. 47 kg

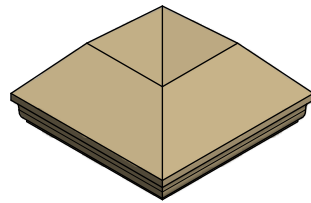

MC400-2X90 - INT/EXT 90°
APPROX. 31 kg

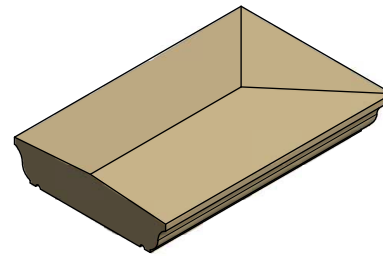

MC400-2L - HIP-END
APPROX. 45 kg

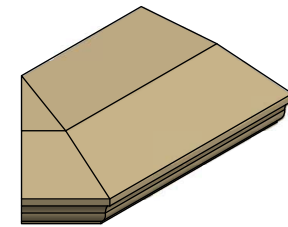

MC400-2X45L - INT/EXT 45° L/H (AS DRAWN)
MC400-2X45R - INT/EXT 45° R/H (HANDED)
APPROX. 38 kg

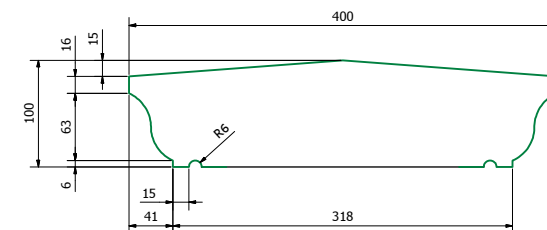
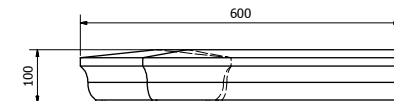
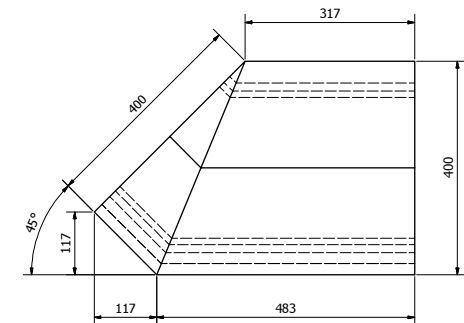
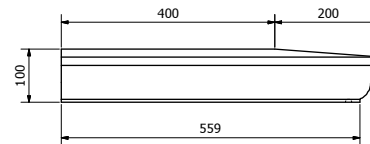
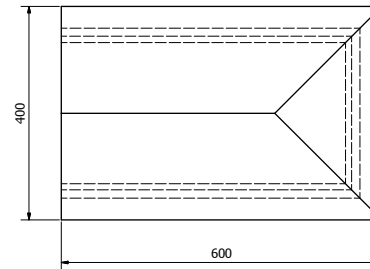
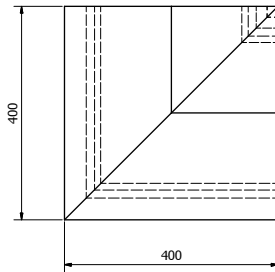
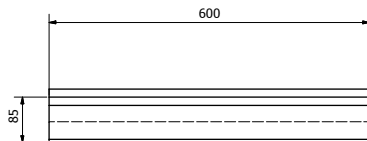
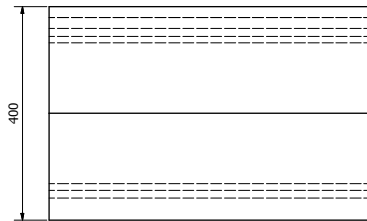

TYPICAL SECTION (1 : 2.5)

VOBSTER

ARCHITECTURAL

Vobster Architectural
Newbury Works
Coleford, Radstock
Somerset, BA3 9RX
T: +44 (0)203 968 7058
E: enquiries@vobsterarchitectural.co.uk
W: www.vobsterarchitectural.co.uk

It is the responsibility of the customer to ensure the suitability of any of these products within their project. Vobster Call Three Ltd. can accept no responsibility for the accuracy or suitability of any information produced and offer no warranty whatsoever in this respect. All units weigh approx. 2.4 tonnes/m² although this will depend on the chosen rns design - please therefore contact us for confirmation of weights.

To comply with CEN regulations please notify us if you require lifting sockets to be incorporated into units at time of order.

KEY

— DENOTES FINISHED FACES

→ DENOTES DIRECTION OF WEATHERING

SCALE 1:5 U.S.O.

TITLE

2 x WEATHERED COPING (MC400-2)

Drawing No. VC-MCP2-01 **Rev** ^

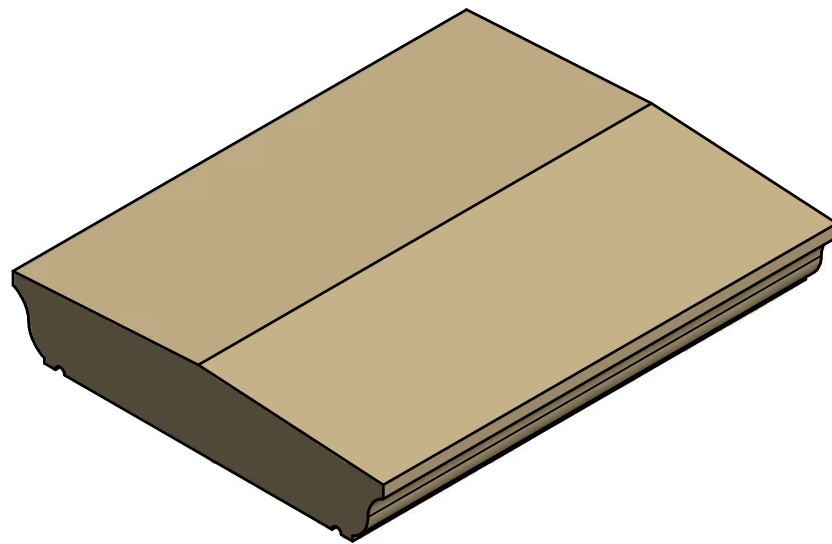

MC490-2 COPING

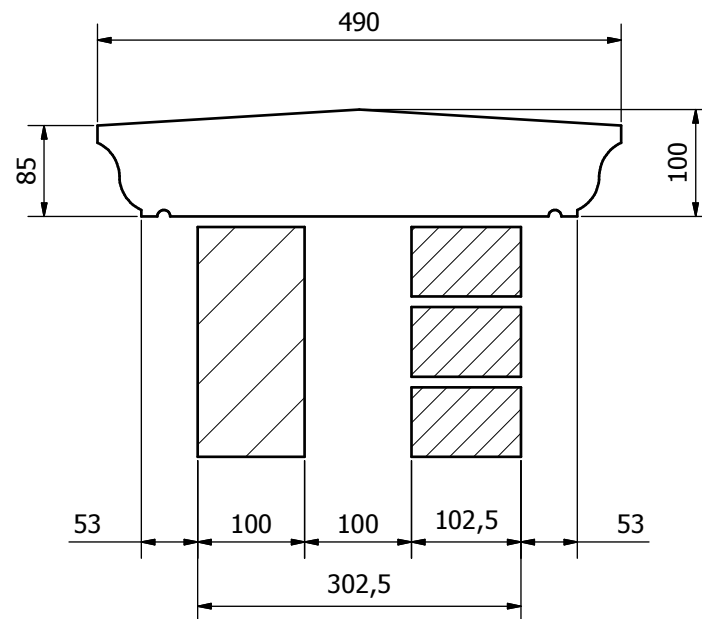

TYPICAL SECTION (302mm WALL)

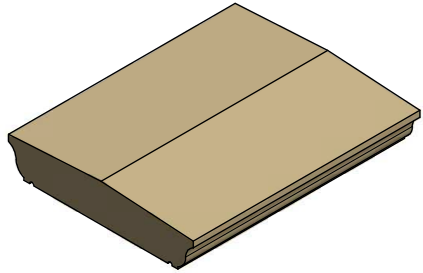

MC490-2 - STRAIGHT
APPROX. 58 kg

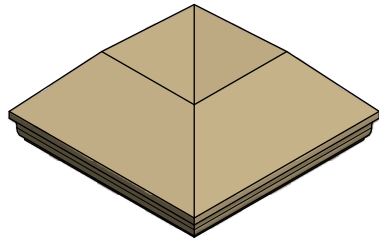

MC490-2X90 - INT/EXT 90°
APPROX. 47 kg

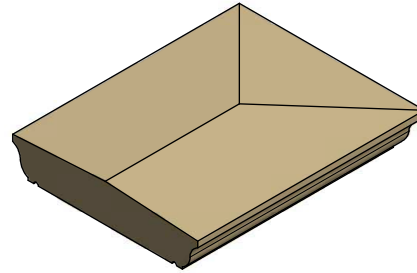

MC490-2L - HIP-END
APPROX. 56 kg

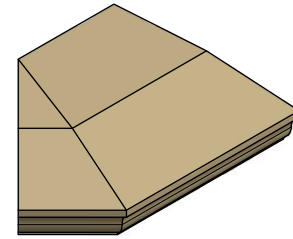

MC490-2X45L - INT/EXT 45° L/H (AS DRAWN)
MC490-2X45R - INT/EXT 45° R/H (HANDED)
APPROX. 44 kg

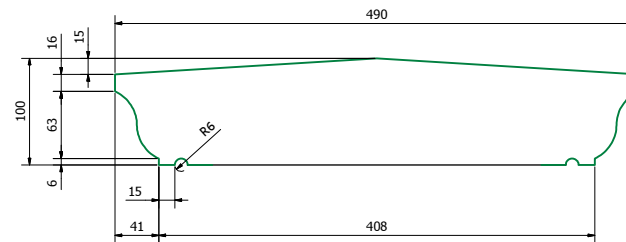
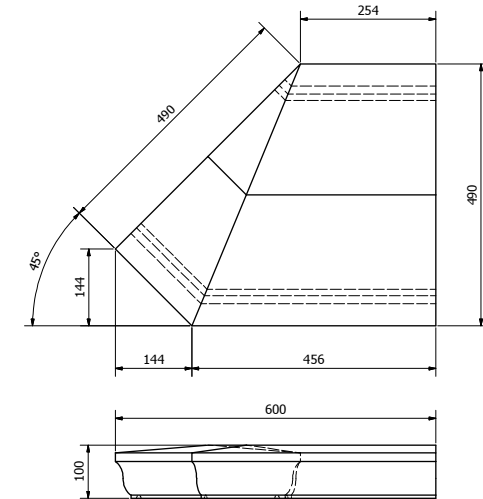
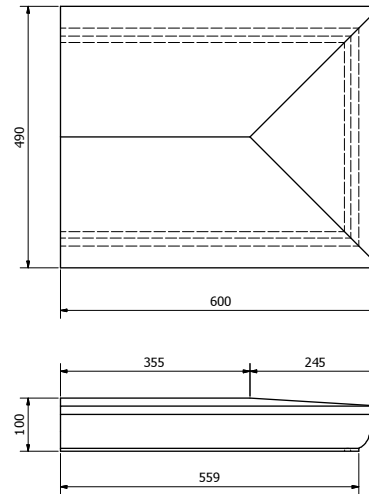
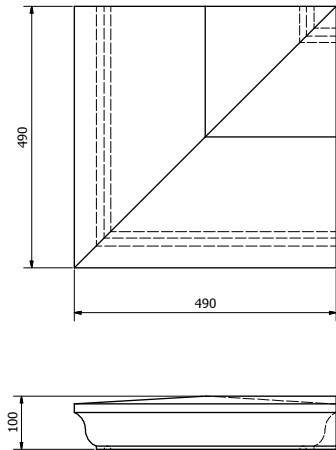
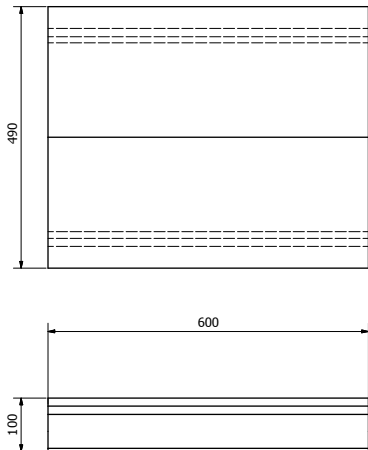

TYPICAL SECTION (1 : 2.5)

VOBSTER
ARCHITECTURAL

Vobster Architectural
Newbury Works
Coleford, Radstock
Somerset, BA3 8RX
Tel: +44 (0)203 968 7058
Email: enquiries@vobsterarchitectural.co.uk
Web: www.vobsterarchitectural.co.uk

It is the responsibility of the customer to ensure the suitability of any of these products within their project. Vobster Call Three Ltd. can accept no responsibility for the accuracy or suitability of any information produced and offer no warranty whatsoever in this respect. All units weigh approx. 2.4 tonnes/m² although this will depend on the chosen mix design - please therefore contact us for confirmation of weights. To comply with CEN regulations please notify us if you require lifting sockets to be incorporated into units at time of order.

KEY
— DENOTES FINISHED FACES
— DENOTES DIRECTION OF WEATHERING

SCALE 1:5 U.S.O.

TITLE
2 x WEATHERED COPING (MC490-2)

Drawing No. VC-MCP2-02 **Rev** 1

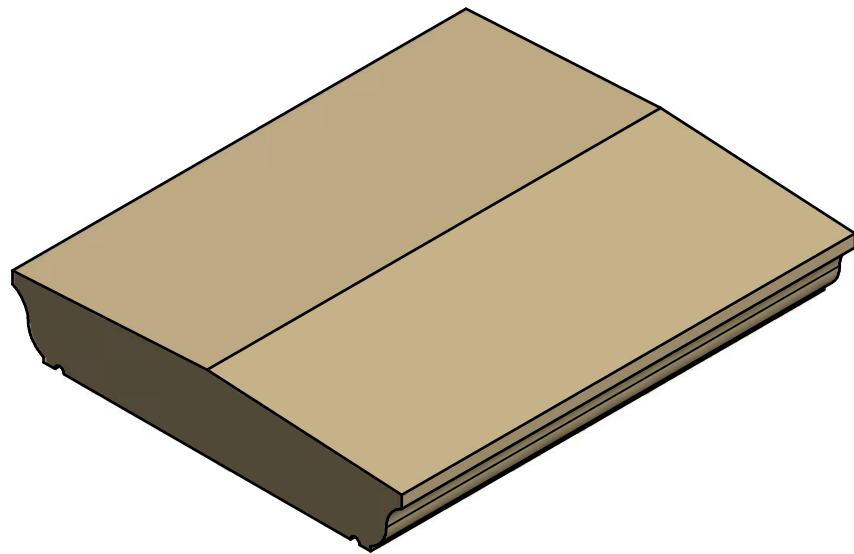

MC515-2 COPING

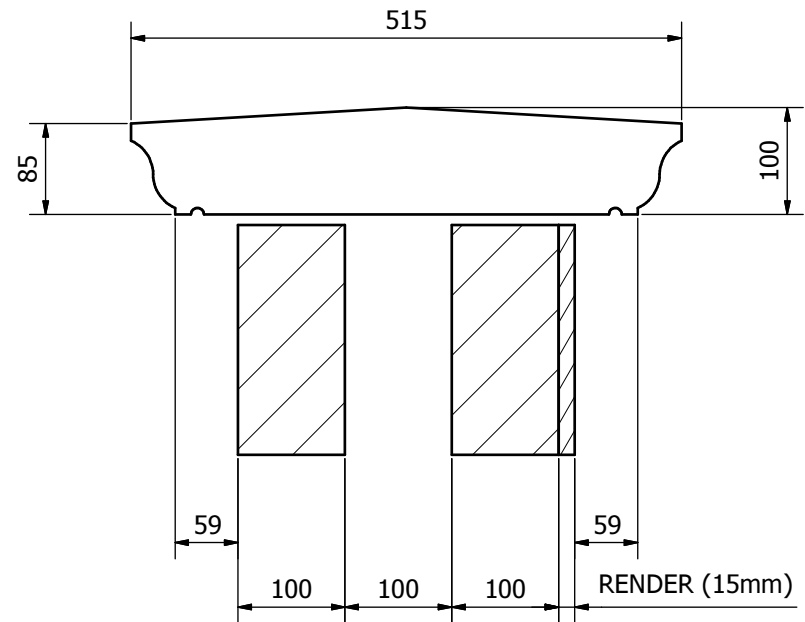

TYPICAL SECTION

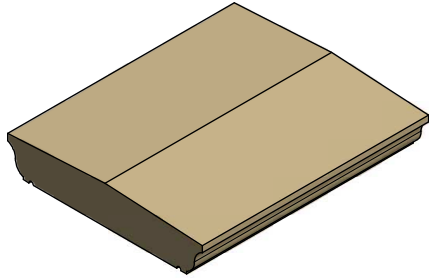

MC515-2 - STRAIGHT
APPROX. 61 kg

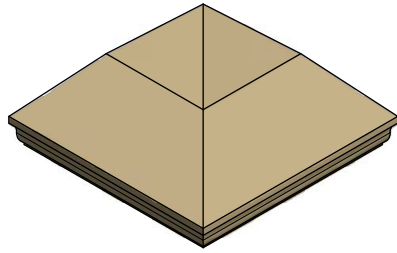

MC515-2X90 - INT/EXT 90°
APPROX. 53 kg

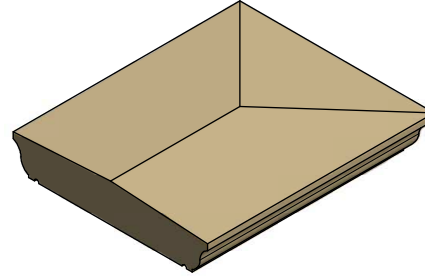

MC515-2L - HIP-END
APPROX. 59 kg

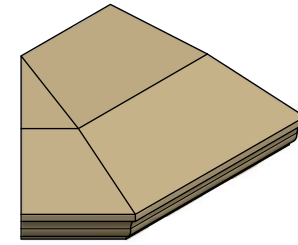

MC515-2X45L - INT/EXT 45° L/H (AS DRAWN)
MC515-2X45R - INT/EXT 45° R/H (HANDED)
APPROX. 46 kg

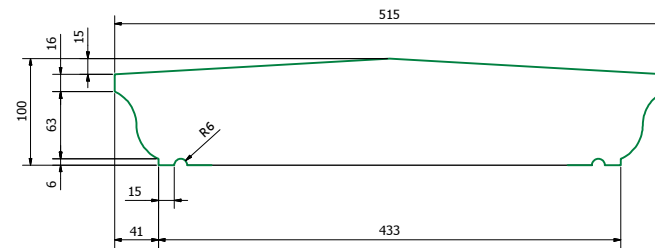
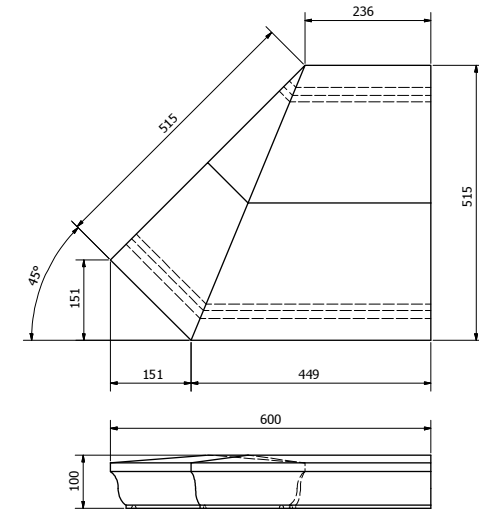
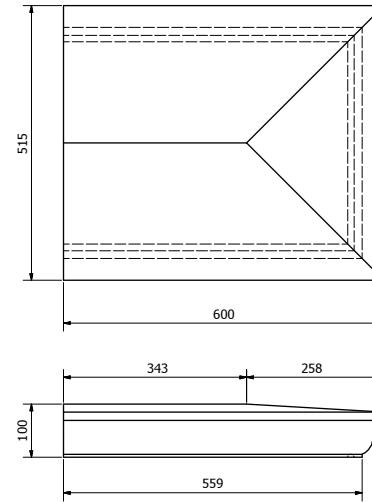
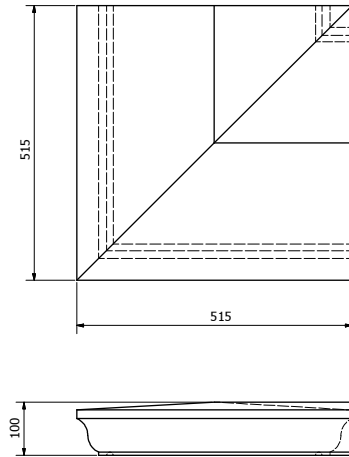
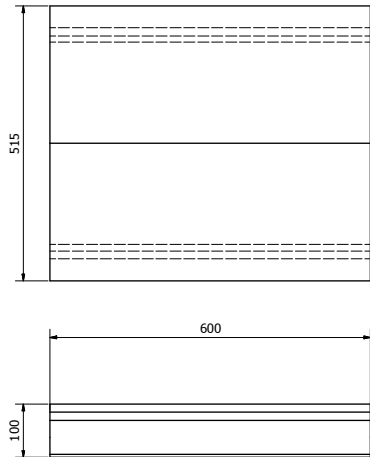

TYPICAL SECTION (1 : 2.5)

VOBSTER
ARCHITECTURAL

Vobster Architectural
Newbury Works
Coleford, Radstock
Somerset, BA3 5RX
Tel: +44 (0)203 968 7058
Email: enquiries@vobsterarchitectural.co.uk
Web: www.vobsterarchitectural.co.uk

It is the responsibility of the customer to ensure the suitability of any of these products within their project. Vobster Architectural cannot accept any responsibility for the accuracy or suitability of any information produced and offer no warranty whatsoever in this respect. All units weigh approx. 2.4 tonnes/m² although this will depend on the chosen mix design - please therefore contact us for confirmation of weights. To comply with CEN regulations please notify us if you require lifting sockets to be incorporated into units at time of order.

KEY
— DENOTES FINISHED FACES
— DENOTES DIRECTION OF WEATHERING

SCALE 1:5 U.S.O.

TITLE
2 x WEATHERED COPING (MC515-2)

Drawing No. VC-MCP2-03 **Rev** 1