

'LH TYPE HEAD'
100mm BED x 140mm HIGH
ONE PIECE (OVERALL LENGTH <1547mm)

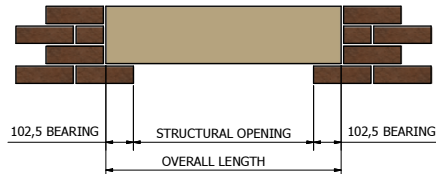

'DH TYPE HEAD'
100mm BED x 215mm HIGH
ONE PIECE (OVERALL LENGTH <1547mm)

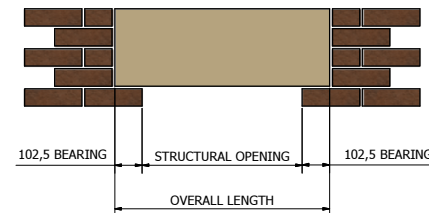

'GH TYPE HEAD'
100mm BED x 290mm HIGH
ONE PIECE (OVERALL LENGTH <1547mm)

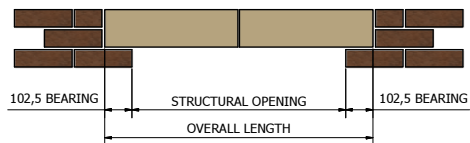

'LH TYPE HEAD'
100mm BED x 140mm HIGH
TWO PIECES (OVERALL LENGTH >1547mm)

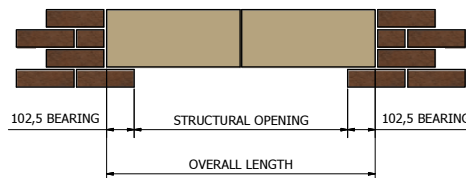

'DH TYPE HEAD'
100mm BED x 215mm HIGH
TWO PIECES (OVERALL LENGTH >1547mm)

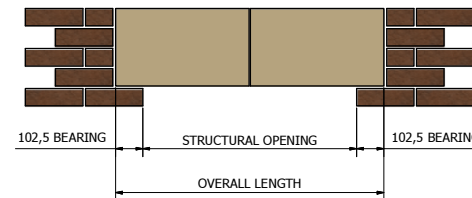

'GH TYPE HEAD'
100mm BED x 290mm HIGH
TWO PIECES (OVERALL LENGTH >1547mm)

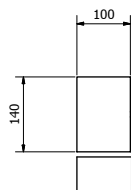

TYPICAL 'LH' SECTION

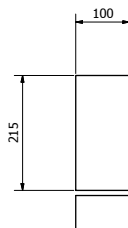

TYPICAL 'DH' SECTION

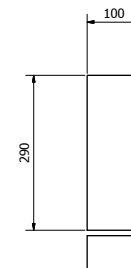

TYPICAL 'GH' SECTION

NOTE:
-ONE-PIECE HEADS SELF SUPPORTING ONLY,
REQUIRING RELIEVING CATNIC OR SIMILAR ABOVE/BELOW
-TWO-PIECE HEADS REQUIRE RELIEVING CATNIC OR SIMILAR BELOW
-STRUCTURAL HEADS DESIGNED/SUPPLIED ON REQUEST

VOBSTER ARCHITECTURAL	
Vobster Architectural Newbury Works Coleford, Radstock Somerset, BA3 5RX Tel: +44 (0)203 968 7058 Email: enquiries@vobsterarchitectural.co.uk Web: www.vobsterarchitectural.co.uk	
<small>It is the responsibility of the customer to ensure the suitability of any of these products within their project. Vobster Architectural Ltd. can accept no responsibility for the accuracy or suitability of any information produced and offer no warranty whatsoever in this respect. All units weigh approx. 2.4 tonnes/m² although this will depend on the chosen mix design - please therefore contact us for confirmation of weights. To comply with CEN regulations please notify us if you require lifting sockets to be incorporated into units at time of order.</small>	
KEY DENOTES FINISHED FACES DENOTES DIRECTION OF WEATHERING	
SCALE 1:10 U.S.O.	
TITLE PLAIN HEADS IN BRICK	
Drawing No. VC-BHP-01	Rev

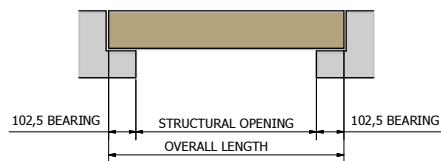

'LHR TYPE HEAD'
120mm BED x 140mm HIGH
ONE PIECE (OVERALL LENGTH <1547mm)

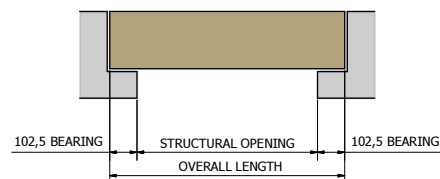

'DHR TYPE HEAD'
120mm BED x 215mm HIGH
ONE PIECE (OVERALL LENGTH <1547mm)

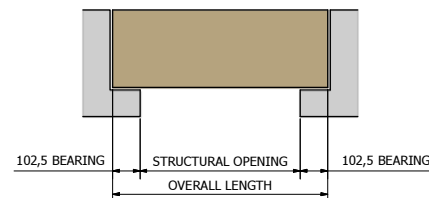

'GHR TYPE HEAD'
120mm BED x 290mm HIGH
ONE PIECE (OVERALL LENGTH <1547mm)

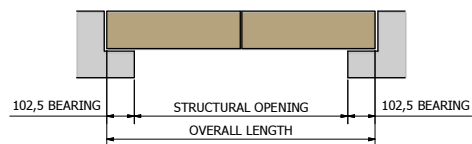

'LHR TYPE HEAD'
120mm BED x 140mm HIGH
TWO PIECES (OVERALL LENGTH >1547mm)

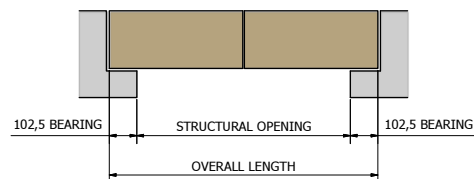

'DHR TYPE HEAD'
120mm BED x 215mm HIGH
TWO PIECES (OVERALL LENGTH >1547mm)

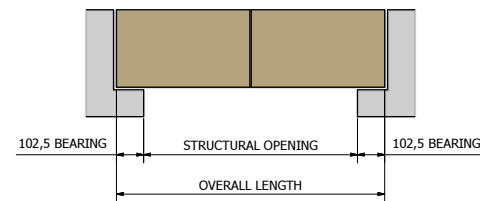

'GHR TYPE HEAD'
120mm BED x 290mm HIGH
TWO PIECES (OVERALL LENGTH >1547mm)

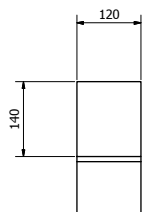

TYPICAL 'LHR' SECTION

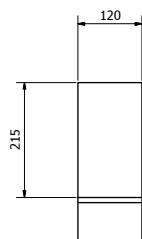

TYPICAL 'DHR' SECTION

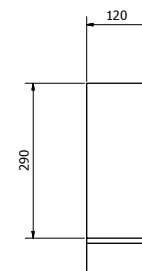

TYPICAL 'GHR' SECTION

NOTE:
-ONE-PIECE HEADS SELF SUPPORTING ONLY,
REQUIRING RELIEVING CATNIC OR SIMILAR ABOVE/BELOW
-TWO-PIECE HEADS REQUIRE RELIEVING CATNIC OR SIMILAR BELOW
-STRUCTURAL HEADS DESIGNED/SUPPLIED ON REQUEST

VOBSTER ARCHITECTURAL	
Vobster Architectural Newbury Works Coleford, Radstock Somerset, BA3 9RX T: +44 (0)203 968 7058 E: enquiries@vobsterarchitectural.co.uk W: www.vobsterarchitectural.co.uk	
It is the responsibility of the customer to ensure the suitability of any of these products within their project. Vobster Cat Three Ltd. can accept no responsibility for the accuracy or suitability of any information produced and offer no warranty whatsoever in this respect. All units weigh approx. 2.4 tonnes/m² although this will depend on the chosen rix design - please therefore contact us for confirmation of weights. To comply with C.O.M regulations please notify us if you require lifting sockets to be incorporated into units at time of order.	
KEY	
— DENOTES FINISHED FACES	
→ DENOTES DIRECTION OF WEATHERING	
SCALE	1:10 U.S.O.
TITLE	PLAIN HEADS IN RENDER
Drawing No.	VC-RHP-01
Rev	

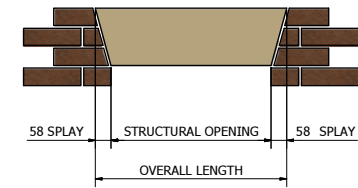

'SH TYPE HEAD'
100mm BED x 215mm HIGH
ONE PIECE (OVERALL LENGTH <1000mm)

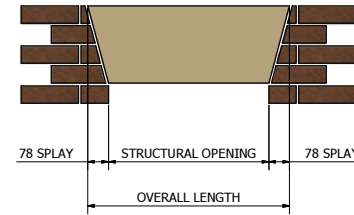

'JH TYPE HEAD'
100mm BED x 290mm HIGH
ONE PIECE (OVERALL LENGTH <1000mm)

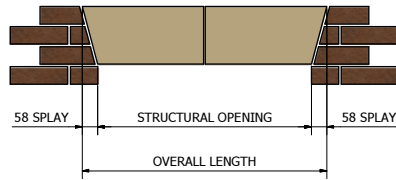

'SH TYPE HEAD'
100mm BED x 215mm HIGH
TWO PIECES (OVERALL LENGTH >1000mm)

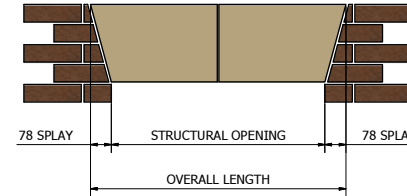

'JH TYPE HEAD'
100mm BED x 290mm HIGH
TWO PIECES (OVERALL LENGTH >1000mm)

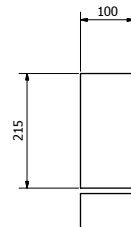

TYPICAL 'SH' SECTION

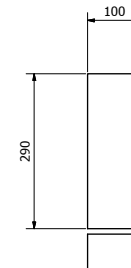

TYPICAL 'JH' SECTION

VOBSTER ARCHITECTURAL	
Vobster Architectural Newbury Works Coleford, Radstock Somerset, BA3 9RX T: +44 (0)203 968 7058 E: enquiries@vobsterarchitectural.co.uk W: www.vobsterarchitectural.co.uk	
<small>It is the responsibility of the customer to ensure the suitability of any of these products within their project. Vobster/Cast Stone Ltd. can accept no responsibility for the accuracy or suitability of any information produced and offer no warranty whatsoever in this respect. All units weigh approx. 2.4 tonnes/m² although this will depend on the chosen mix design - please therefore contact us for confirmation of weights. To comply with CEN regulations please notify us if you require lifting sockets to be incorporated into units at time of order.</small>	
KEY DENOTES FINISHED FACES DENOTES DIRECTION OF WEATHERING	
SCALE	1:10 U.S.O.
TITLE SPLAYED HEADS IN BRICK	
Drawing No. VC-BHS-01 Rev	

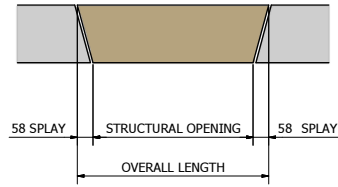

'SHR TYPE HEAD'
120mm BED x 215mm HIGH
ONE PIECE (OVERALL LENGTH <1000mm)

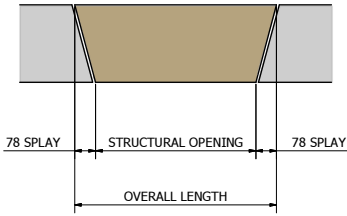

'JHR TYPE HEAD'
120mm BED x 290mm HIGH
ONE PIECE (OVERALL LENGTH <1000mm)

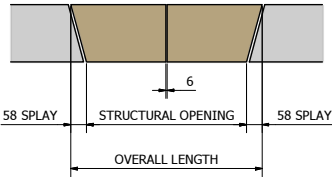

'SHR TYPE HEAD'
120mm BED x 215mm HIGH
TWO PIECES (OVERALL LENGTH >1000mm)

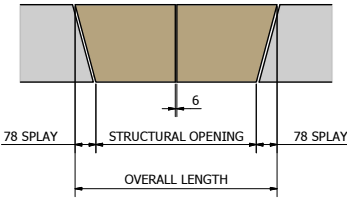

'JHR TYPE HEAD'
120mm BED x 290mm HIGH
TWO PIECES (OVERALL LENGTH >1000mm)

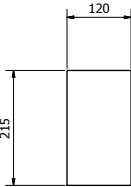

TYPICAL 'SHR' SECTION

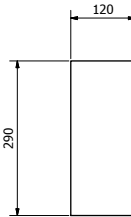

TYPICAL 'JHR' SECTION

VOBSTER

ARCHITECTURAL

Vobster Architectural

Newbury Works

Coleford, Radstock

Somerset, BA3 9RX

T: +44 (0)203 968 7058

E: enquiries@vobsterarchitectural.co.uk

W: www.vobsterarchitectural.co.uk

It is the responsibility of the customer to ensure the suitability of any of these products within their project. Vobster Cast Stone Ltd. can accept no responsibility for the accuracy or suitability of any information produced and offer no warranty whatsoever in this respect. All units weigh approx. 2.4 tonnes/m² although this will depend on the chosen rim design - please therefore contact us for confirmation of weights. To comply with C.S. regulations please notify us if you require lifting sockets to be incorporated into units at time of order.

KEY

—

 DENOTES FINISHED FACES

→

 DENOTES DIRECTION OF WEATHERING

SCALE

1:10 U.S.O.

TITLE

SPLAYED HEADS IN RENDER

Drawing No.

VC-RHS-01

Rev

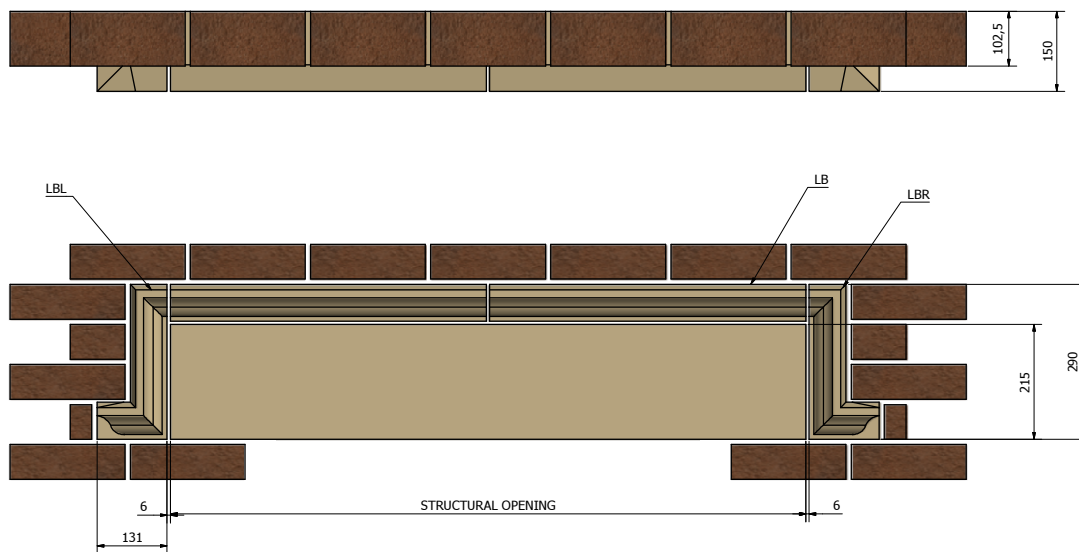

'LB' TYPE LABEL MOULDING OVER 215mm DEEP 'DH' HEAD

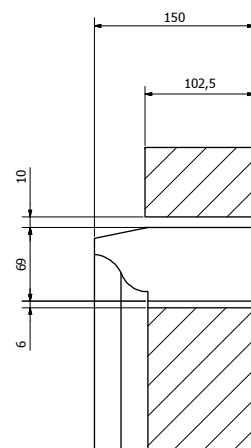

TYPICAL 'LB' SECTION

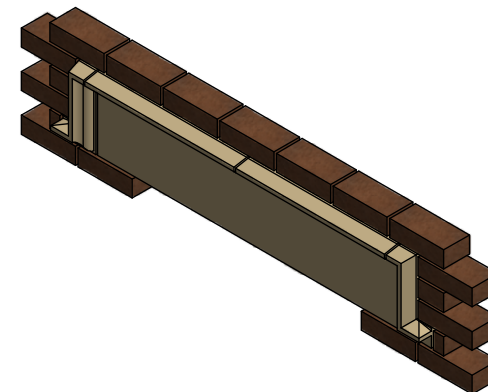

VOBSTER ARCHITECTURAL	
Vobster Architectural Newbury Works Coleford, Radstock Somerset, BA3 9RX T: +44 (0)203 968 7058 E: enquiries@vobsterarchitectural.co.uk W: www.vobsterarchitectural.co.uk	
<small> It is the responsibility of the customer to ensure the suitability of any of these products within their project. Vobster Architectural cannot accept responsibility for the accuracy or suitability of any information produced and offer no warranty whatsoever in this respect. All units weigh approx. 2.4 tonnes/m² although this will depend on the chosen mix design - please therefore contact us for confirmation of weights. To comply with C.E.M. regulations please notify us if you require lifting sockets to be incorporated into units at time of order. </small>	
KEY — DENOTES FINISHED FACES — DENOTES DIRECTION OF WEATHERING	
SCALE	1:10 U.S.O.
TITLE LABEL MOULDING	
Drawing No. VC-LM-01	Rev