

K1 KEYSTONE IN 140mm HIGH HEAD ( 1 : 5 )  
APPROX. 14 KG

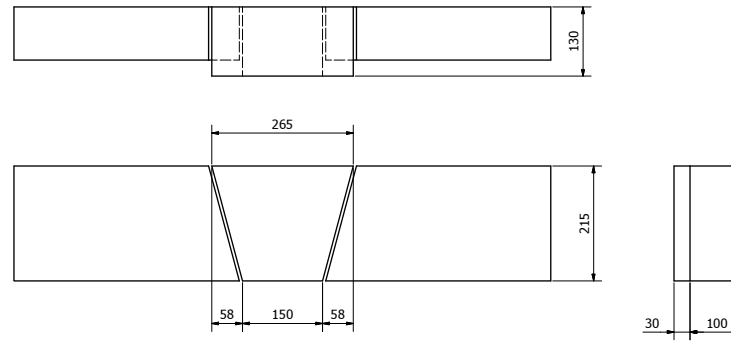

K1 KEYSTONE IN 215mm HIGH HEAD ( 1 : 5 )  
APPROX. 14 KG

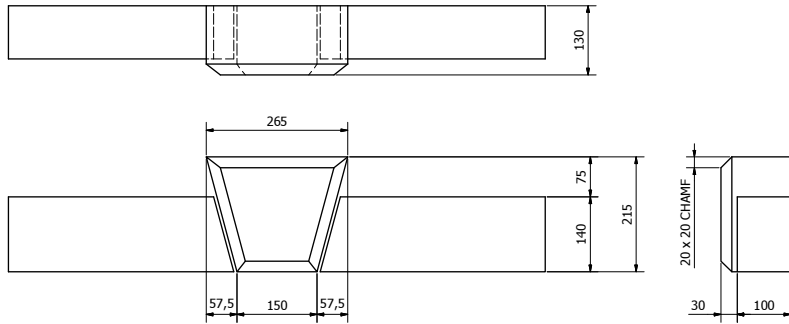

K1C CHAMFERED KEYSTONE  
IN 140mm HIGH HEAD ( 1 : 5 )  
APPROX. 13 KG

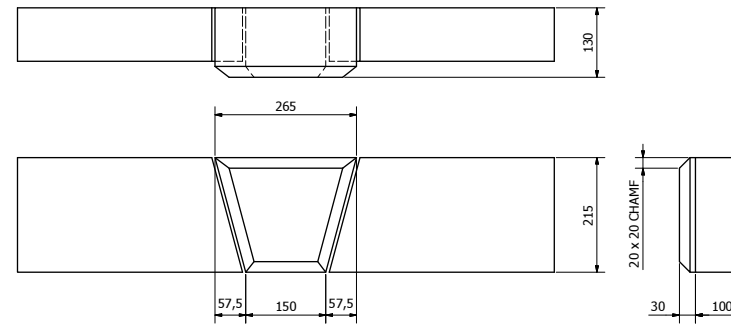

K1C CHAMFERED KEYSTONE  
IN 215mm HIGH HEAD ( 1 : 5 )  
APPROX. 13 KG

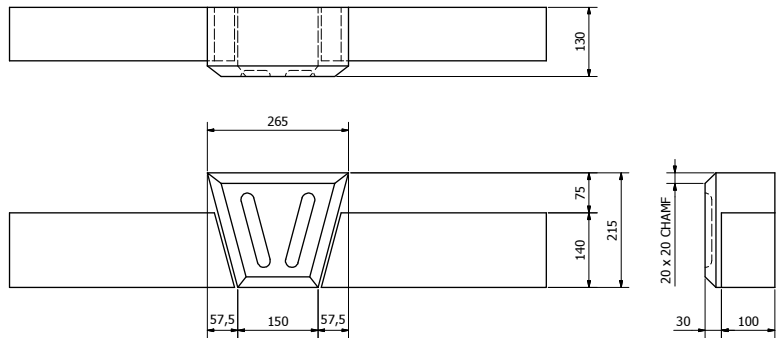

K1F FLUTED KEYSTONE  
IN 140mm HIGH HEAD ( 1 : 5 )  
APPROX. 13 KG

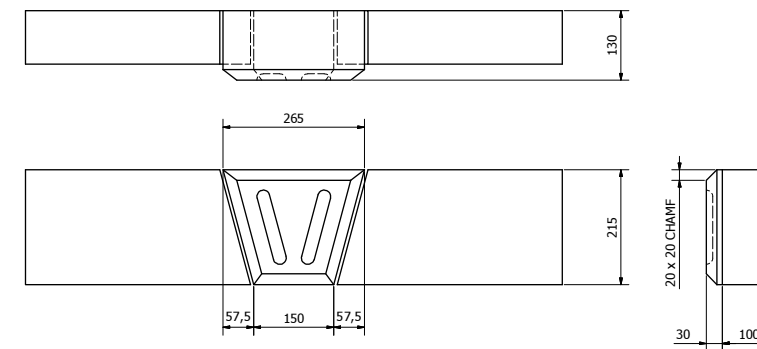

K1F FLUTED KEYSTONE  
IN 215mm HIGH HEAD ( 1 : 5 )  
APPROX. 13 KG

**VOBSTER**  
ARCHITECTURAL

Vobster Architectural  
Newbury Works  
Coleford, Radstock  
Somerset, BA3 9RX  
T: +44 (0)1203 968 7958  
E: enquiries@vobsterarchitectural.co.uk  
W: www.vobsterarchitectural.co.uk

It is the responsibility of the customer to ensure the suitability of any of these products within their project. Vobster Cast Stone Ltd. can accept no responsibility for the accuracy or suitability of any information produced and offer no warranty whatsoever in this respect. All units weigh approx. 2.4 tonnes/m<sup>2</sup> although this will depend on the chosen mix design - please therefore contact us for confirmation of weights. To comply with c.c.m regulations please notify us if you require lifting sockets to be incorporated into units at time of order.

**KEY**  
— DENOTES FINISHED FACES  
— DENOTES DIRECTION OF WEATHERING

**SCALE** 1:10 U.S.O.

**TITLE**  
K1 SOLID KEYSTONE (215mm)

**Drawing No.** VC-KS-01 **Rev** 7

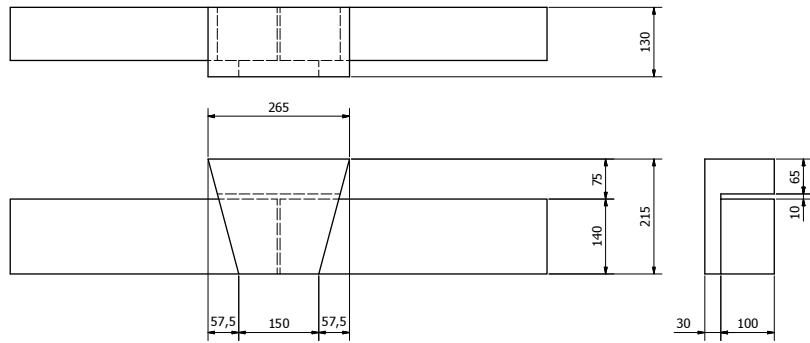

K2 KEYSTONE OVER 140mm HIGH HEAD ( 1 : 5 )  
APPROX. 7 KG

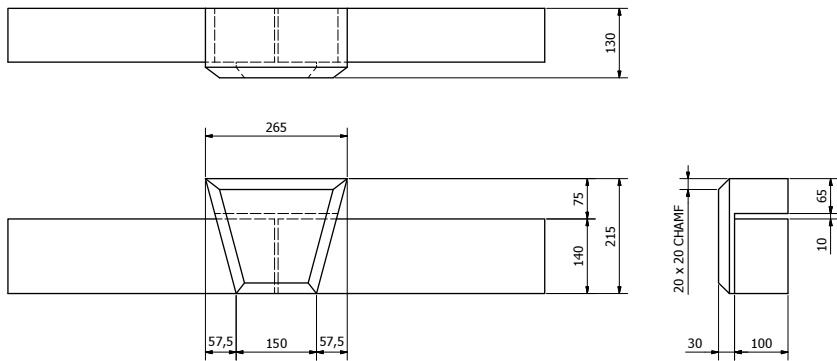

K2C CHAMFERED KEYSTONE OVER 140mm HIGH HEAD ( 1 : 5 )  
APPROX. 7 KG

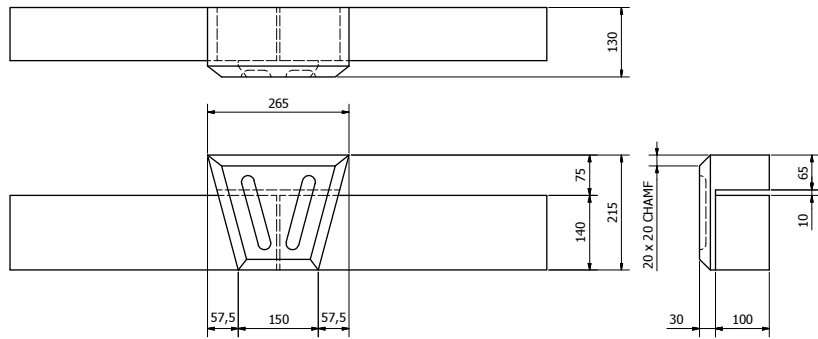

K2F FLUTED KEYSTONE OVER 140mm HIGH HEAD ( 1 : 5 )  
APPROX. 7 KG

**VOBSTER**  
ARCHITECTURAL

Vobster Architectural  
Newbury Works  
Coleford, Radstock  
Somerset, BA3 5RX  
T: +44 (0)203 968 7056  
E: enquiry@vobsterarchitectural.co.uk  
W: www.vobsterarchitectural.co.uk

It is the responsibility of the customer to ensure the suitability of any of these products within their project. Vobster Cast Stone Ltd. can accept no responsibility for the accuracy or suitability of any information produced and offer no warranty whatsoever in this respect. All units weigh approx. 2.4 tonnes/m<sup>2</sup> although this will depend on the chosen mix design - please therefore contact us for confirmation of weights. To comply with c.c.m regulations please notify us if you require lifting sockets to be incorporated into units at time of order.

**KEY**  
— DENOTES FINISHED FACES  
→ DENOTES DIRECTION OF WEATHERING

**SCALE** 1:10 U.S.O.

**TITLE**  
K2 SLIP-OVER KEYSTONE (215mm)

**Drawing No.** VC-KS-02 **Rev** 7

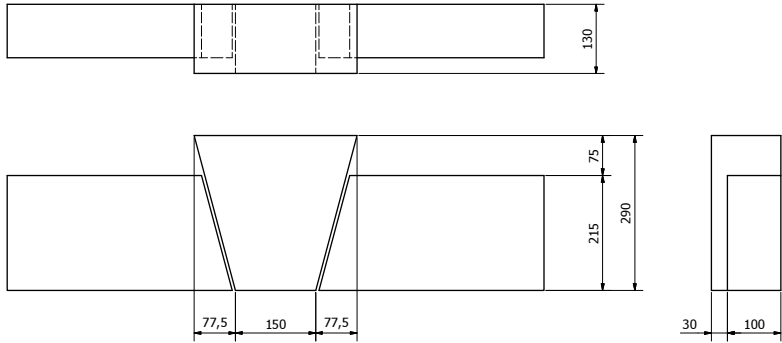

K3 KEYSTONE IN 215mm HIGH HEAD ( 1 : 5 )  
APPROX. 20 KG

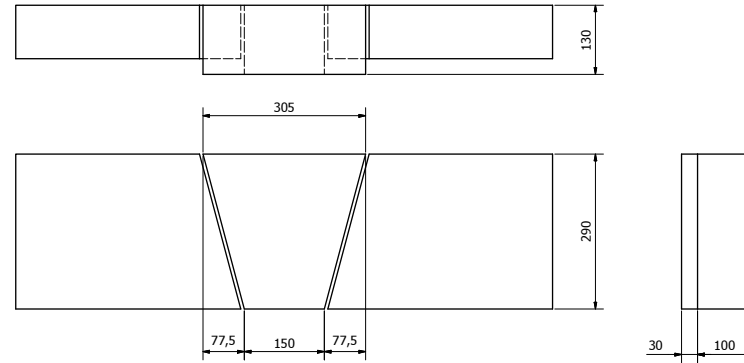

K3 KEYSTONE IN 290mm HIGH HEAD ( 1 : 5 )  
APPROX. 20 KG

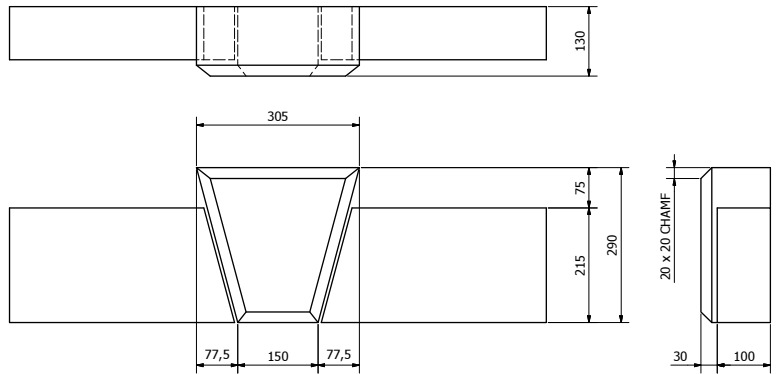

K3C KEYSTONE IN 215mm HIGH HEAD ( 1 : 5 )  
APPROX. 20 KG

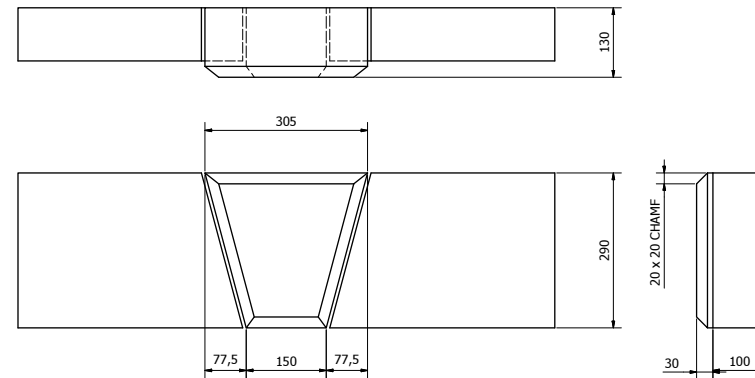

K3C KEYSTONE IN 290mm HIGH HEAD ( 1 : 5 )  
APPROX. 20 KG

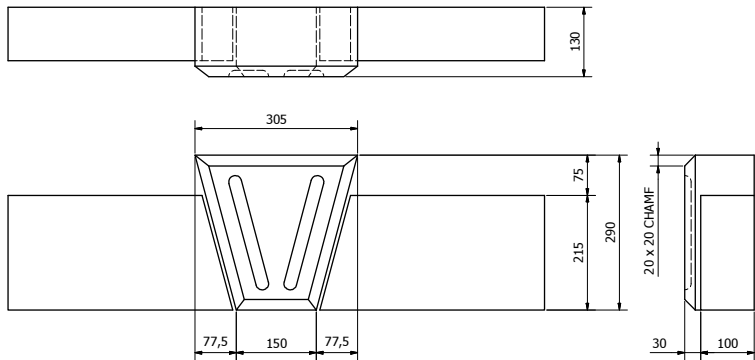

K3F KEYSTONE IN 215mm HIGH HEAD ( 1 : 5 )  
APPROX. 20 KG

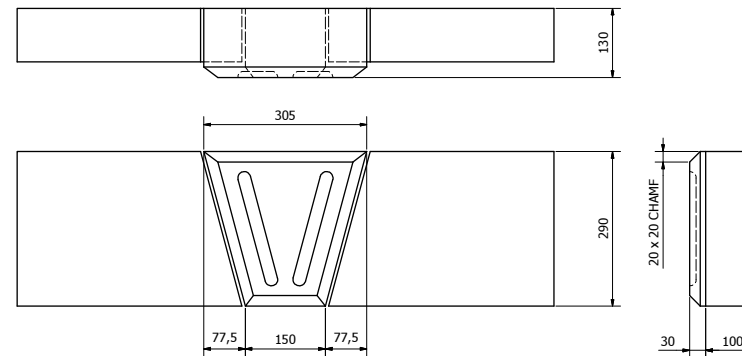

K3F KEYSTONE IN 290mm HIGH HEAD ( 1 : 5 )  
APPROX. 20 KG

**VOBSTER**  
ARCHITECTURAL

Vobster Architectural  
Newbury Works  
Coleford, Radstock  
Somerset, BA3 9RX  
T: +44 (0)203 968 7058  
E: enquiries@vobsterarchitectural.co.uk  
W: www.vobsterarchitectural.co.uk

It is the responsibility of the customer to ensure the suitability of any of these products within their project. Vobster Cast Stone Ltd. can accept no responsibility for the accuracy or suitability of any information produced and offer no warranty whatsoever in this respect. All units weigh approx. 2.4 tonnes/m<sup>3</sup> although this will depend on the chosen mix design - please therefore contact us for confirmation of weights. To comply with c.c.m regulations please notify us if you require lifting sockets to be incorporated into units at time of order.

**KEY**  
— DENOTES FINISHED FACES  
→ DENOTES DIRECTION OF WEATHERING

**SCALE** 1:10 U.S.O.

**TITLE**  
K3 SOLID KEYSTONE (290mm)

**Drawing No.** VC-KS-03 **Rev** 7

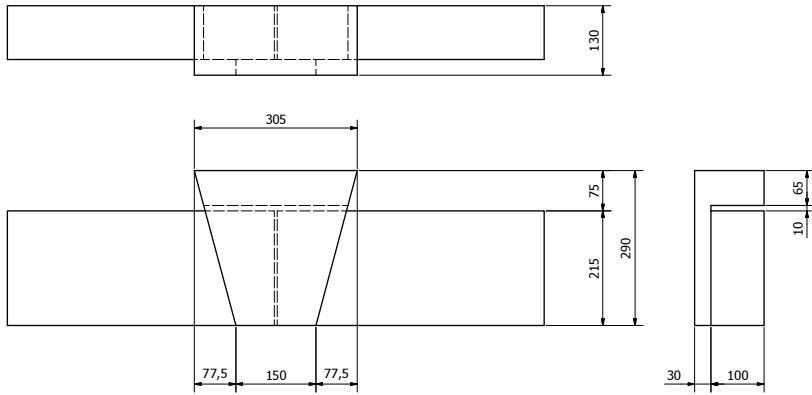

K4 KEYSTONE OVER 215mm HIGH HEAD ( 1 : 5 )  
APPROX. 9 KG

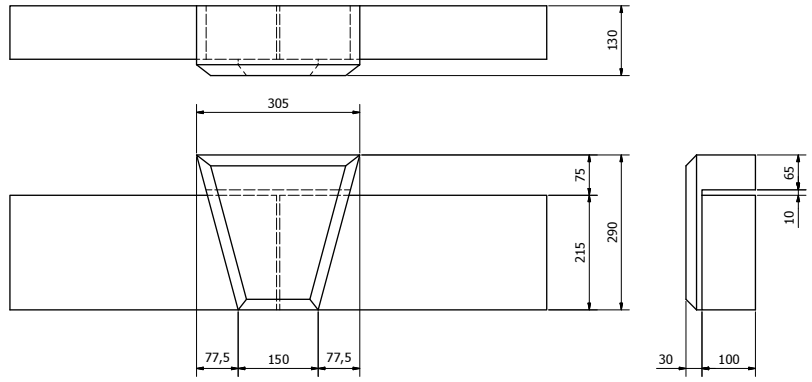

K4C CHAMFERED KEYSTONE OVER 215mm HIGH HEAD ( 1 : 5 )  
APPROX. 9 KG

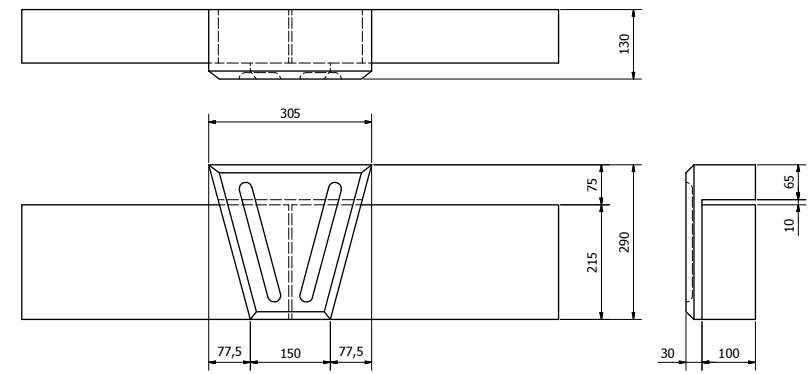

K4F KEYSTONE OVER 215mm HIGH HEAD ( 1 : 5 )  
APPROX. 9 KG

**VOBSTER**  
ARCHITECTURAL

Vobster Architectural  
Newbury Works  
Coleford, Radstock  
Somerset, BA13 9RX  
T: +44 (0)1203 968 7058  
E: enquiries@vobsterarchitectural.co.uk  
W: www.vobsterarchitectural.co.uk

It is the responsibility of the customer to ensure the suitability of any of these products within their project. Vobster Cast Stone Ltd. can accept no responsibility for the accuracy or suitability of any information produced and offer no warranty whatsoever in this respect. All units weigh approx. 2.4 tonnes/m<sup>3</sup> although this will depend on the chosen mix design - please therefore contact us for confirmation of weights. To comply with c.c.m regulations please notify us if you require lifting sockets to be incorporated into units at time of order.

**KEY**  

 DENOTES FINISHED FACES  

 DENOTES DIRECTION OF WEATHERING

**SCALE** 1:10 U.S.O.

**TITLE**  
K-4 SLIP-OVER KEYSTONE (290mm)

**Drawing No.** VC-KS-04 **Rev** 7

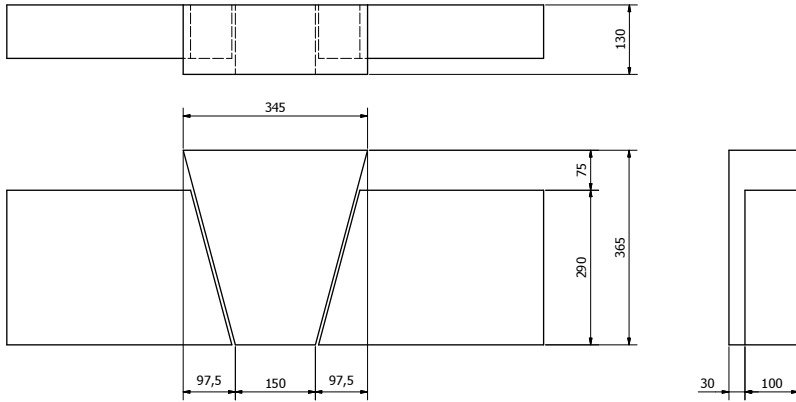

K5 KEYSTONE IN 290mm HIGH HEAD ( 1 : 5 )  
APPROX. 27 KG

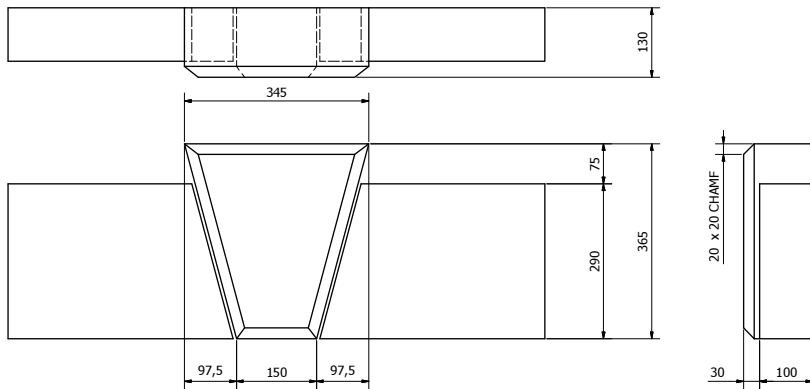

K5C KEYSTONE IN 290mm HIGH HEAD ( 1 : 5 )  
APPROX. 27 KG

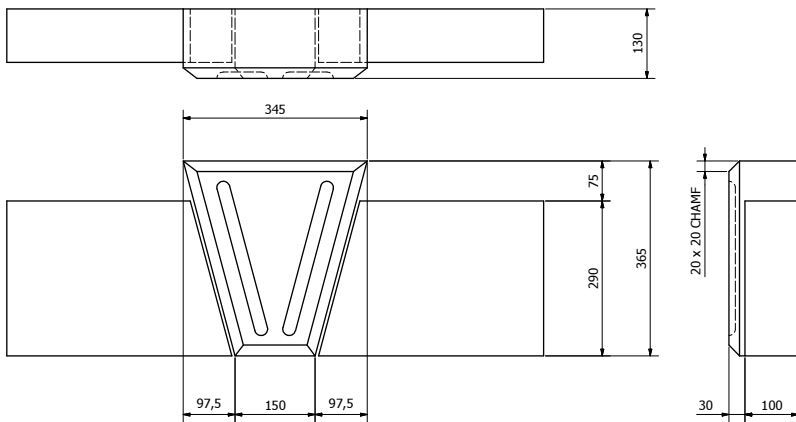

K5F KEYSTONE IN 290mm HIGH HEAD ( 1 : 5 )  
APPROX. 27 KG

**VOBSTER**  
ARCHITECTURAL

Vobster Architectural  
Newbury Works  
Coleford, Radstock  
Somerset, BA3 5RX  
T: +44 (0)1203 968 7058  
E: enquiries@vobsterarchitectural.co.uk  
W: www.vobsterarchitectural.co.uk

It is the responsibility of the customer to ensure the suitability of any of these products within their project. Vobster Cast Stone Ltd. can accept no responsibility for the accuracy or suitability of any information produced and offer no warranty whatsoever in this respect. All units weigh approx. 2.4 tonnes/m<sup>3</sup> although this will depend on the chosen mix design - please therefore contact us for confirmation of weights. To comply with c.c.m regulations please notify us if you require lifting sockets to be incorporated into units at time of order.

**KEY**  

 DENOTES FINISHED FACES  

 DENOTES DIRECTION OF WEATHERING

**SCALE** 1:10 U.S.O.

**TITLE**  
K5 SOLID KEYSTONE (365mm)

**Drawing No.** VC-KS-05 **Rev** 7

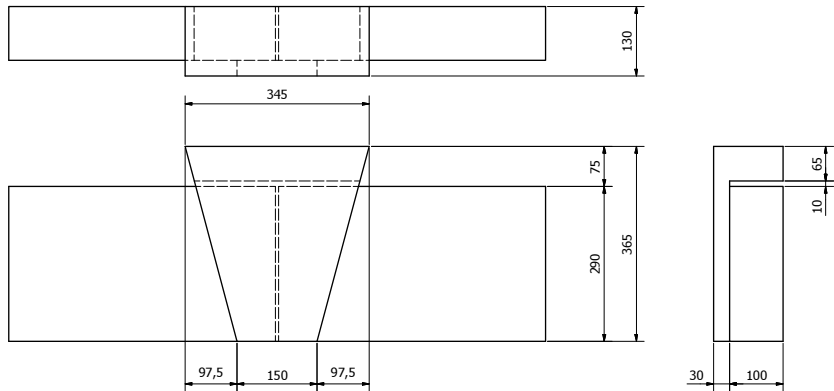

K6 KEYSTONE OVER 290mm HIGH HEAD ( 1 : 5 )  
APPROX. 12 KG

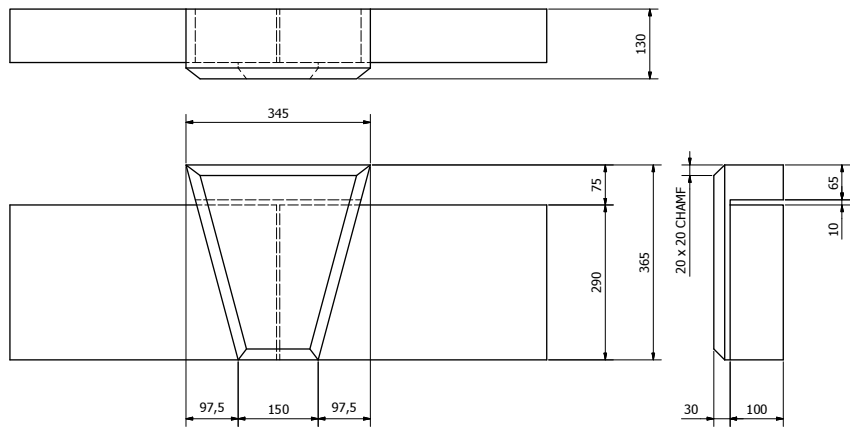

K6C CHAMFERED KEYSTONE OVER 290mm HIGH HEAD ( 1 : 5 )  
APPROX. 12 KG

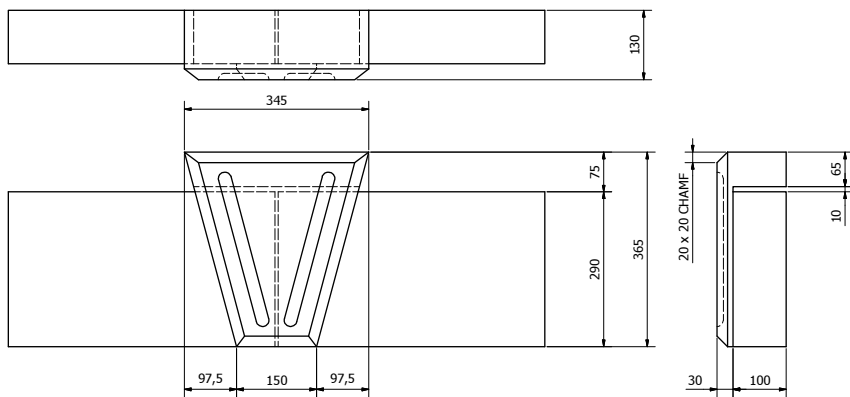

K6F FLUTED KEYSTONE OVER 290mm HIGH HEAD ( 1 : 5 )  
APPROX. 12 KG

**VOBSTER**  
ARCHITECTURAL

Vobster Architectural  
Newbury Works  
Coleford, Radstock  
Somerset, BA3 9BX  
T: +44 (0)1303 968 7058  
E: enquiries@vobsterarchitectural.co.uk  
W: www.vobsterarchitectural.co.uk

It is the responsibility of the customer to ensure the suitability of any of these products within their project. Vobster Cast Stone Ltd. can accept no responsibility for the accuracy or suitability of any information produced and offer no warranty whatsoever in this respect. All units weigh approx. 2.4 tonnes/m<sup>2</sup> although this will depend on the chosen mix design - please therefore contact us for confirmation of weights. To comply with c.c.m regulations please notify us if you require lifting sockets to be incorporated into units at time of order.

**KEY**  

 DENOTES FINISHED FACES  

 DENOTES DIRECTION OF WEATHERING

**SCALE** 1:10 U.S.O.

**TITLE**  
K6 SLIP-OVER KEYSTONE (365mm)

**Drawing No.** VC-KS-06 **Rev** 7